

MIDIPLUS

ED9pro Owner's Manual



CONTENTS

Preface.....	1
What's in the Box?	1
ED9pro Overview	1
Caution	1
Chapter1. Setup	2
1.1. Quick Start.....	2
1.1.1. Choosing Drum Sounds	2
1.1.2. Playing Along with a Song or MP3	2
1.1.3. Practicing with the Metronome	2
1.1.4. Recording Your Performances	2
1.1.5. Playing Your Performances.....	2
1.1.6. Snare Rim shot/Cross stick.....	2
1.2. Overview	3
1.2.1. Front Panel	3
1.2.2. Rear Panel	4
1.3. Basic settings.....	5
1.3.1. Connect drum accessories	5
1.3.2. Connecting the power.....	5
1.3.3. Connect headphones or speakers.....	5
1.3.4. Play the song USB disk (USB MEMORY)	5
1.3.5. USB port	5
1.3.6. Restore factory settings	5
Chapter2. Basic skills.....	6
2.1. Basic operation.....	6
2.1.1. Adjust the volume	6
2.1.2. Select the Drum Kit	6
2.2. Playing in the music accompaniment	6
2.2.1. Select Song	6
2.2.2. Adjust the song volume/ tempo	6
2.2.3. Song of the drum part mute	6
2.2.4. Loop playback of the song	6
2.3. Play music with USB disk (USB MEMORY)	7
2.3.1. Support playback format.....	7
2.3.2. Sequence of music playing priority	7
2.3.3. Selection of music	7
2.3.4. Select play mode	7
2.3.5. Selection music mode	7
2.4. Using the metronome	8

2.4.1.	Start and stop	8
2.4.2.	Adjust the tempo	8
2.5.	Record Performance.....	8
2.5.1.	Recording	8
2.5.2.	Playing	8
Chapter3.	Drum group editor	9
3.1.	Create your own original sound group	9
3.1.1.	Enter edit mode	9
3.1.2.	Select Edit item	9
3.1.3.	Select Edit part	9
3.1.4.	Changing values	9
3.1.5.	Storage edit	9
3.1.6.	Changing values	9
Chapter4.	Advanced Function Setting	9
4.1.	Select the set.....	9
4.2.	Sensitive	10
4.3.	Retrig	10
4.4.	Thresh.....	10
4.5.	Velocity Curve	10
4.6.	Hi-hat splash.....	10
4.7.	Reverb on/off	10
4.8.	X-talk.....	10
4.9.	Surround on/off	10
Chapter5.	Reference	11
5.1.	Inventory data	11
5.1.1.	Drum setting.....	11
5.1.2.	Click setting	11
5.1.3.	Demo setting.....	11
5.1.4.	Advanced setting.....	12
5.2.	Specification	12
5.3.	Drum Voice List	13
Chapter6.	Appendix	16
6.1.	Drum kit assembly.....	17
6.2.	Control box assembly.....	22

Preface

Thank you for buying a ED9pro electronic drums, MIDIPLUS company with the most simple and convenient setting operation mode to make it easier for beginners handy target, please read the instruction manual before use.

What's in the Box?

- One (1) e-drum control Box (Z12K)
- One (1) owner's manual
- One (1) 9V DC power adaptor
- One (1) drum stand (attached assembly diagram).
- One (1) package blow kit accessories.

ED9pro Overview

- Built 20 group preset drum kits, 10 user groups may edit drum set, using a true multi-sampled drum lossless studio recording drums.
- Built-in metronome, 10 demo songs and easy listening learning fast recording function.
- Crash cymbals, support double trigger, cymbals face, cymbals edge and stop tones.
- Ride cymbals, support 3 triggered cymbals face, cymbals heart, cymbal edge and stop tones.
- Pedal cymbals (hi-hat) support closed, semi-open, open, Pedal hi-hat, Foot splash and stop tones.
- Special material multilayer woven mesh drum skin can best simulate real drums crackdown and feel, support dual trigger.
- Kick (Bass drum) and drum kits use a fixed link bracket, firmly positioning drum hit hard step will not shift.
- Snare rim can quickly switch Cross-stick, Rim-shot sound.
- Scalable two Crash cymbals (Crash2) and (Crash3), a fourth Tom drum (Tom4).
- Support USB disk MP3, WAV, Bluetooth audio.

Caution

- Do not place the power cord near heat sources such as heaters or radiators. Also, do not excessively bend or otherwise damage the cord, or place heavy objects on it.
- Only use the voltage specified as correct for the instrument. The required voltage is printed on the name plate of the instrument.
- Use the specified adaptor only. Using the wrong adaptor can result in damage to the instrument or overheating.
- Check the electric plug periodically and remove any dirt or dust which may have accumulated on it.
- Never insert or remove an electric plug with wet hands.
- This instrument contains no user-serviceable parts. Do not open the instrument or attempt to disassemble or modify the internal components in any way

Chapter1. Setup

1.1. Quick Start

1.1.1. Choosing Drum Sounds

1. Press the [Kit] button.
2. Note display subtitles on the screen, use the [value knob] or [+], [-] button to select the type of drum set.
3. Listen percussion drum set type (preset drum kits 20 groups, 10 user-defined groups).

1.1.2. Playing Along with a Song or MP3

1. Not insert a USB disk, or it is no supporting file for USB disk, Press the [SONG] button, play built-in 10 music MIDI song ,LCD display[Midi song 1],[Volume:85 b=140].
2. Insert USB disk, USB disk with MP3 or WAV file, press [Song] button to play the USB disk song files, the LCD display [USB song: 1], [single stop].
3. Turn the [value knob] or [+], [-] button to select the playback.
4. Press the start / stop button [▶/■] to play or stop demo.

1.1.3. Practicing with the Metronome

1. Press the [Click] button.
2. Turn the [value knob] or [+], [-] button to select the tempo.
3. Press the start / stop button [▶/■] to play or stop tempo.

1.1.4. Recording Your Performances

1. Press the [Rec] button.
2. When the lights begin recording.
3. Then click the [Rec] button.
4. After the lights off to stop recording.

1.1.5. Playing Your Performances

1. Press the [Play] button.
2. When the lights begin playing.
3. Then click the [Play] button.
4. After the lights off to stop playing.

1.1.6. Snare Rim shot/Cross stick

1. Press the [Kit] button. Press the [Mute] button to display the top right corner of the screen displays the CS (cross stick).
2. Then click the [Mute] button, CS disappear (rim shot).

1.2. Overview

1.2.1. Front Panel

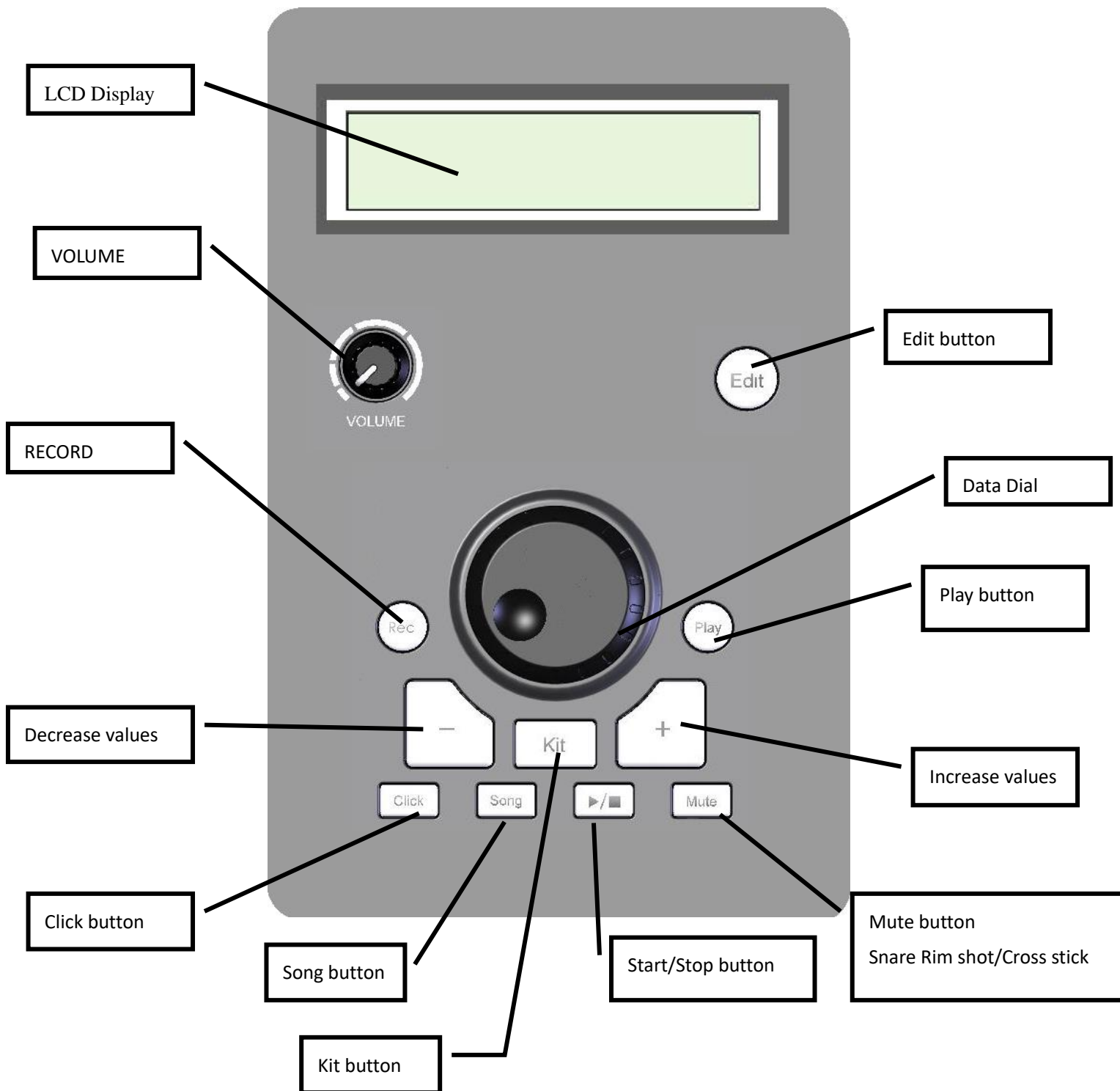

1.2.2. Rear Panel

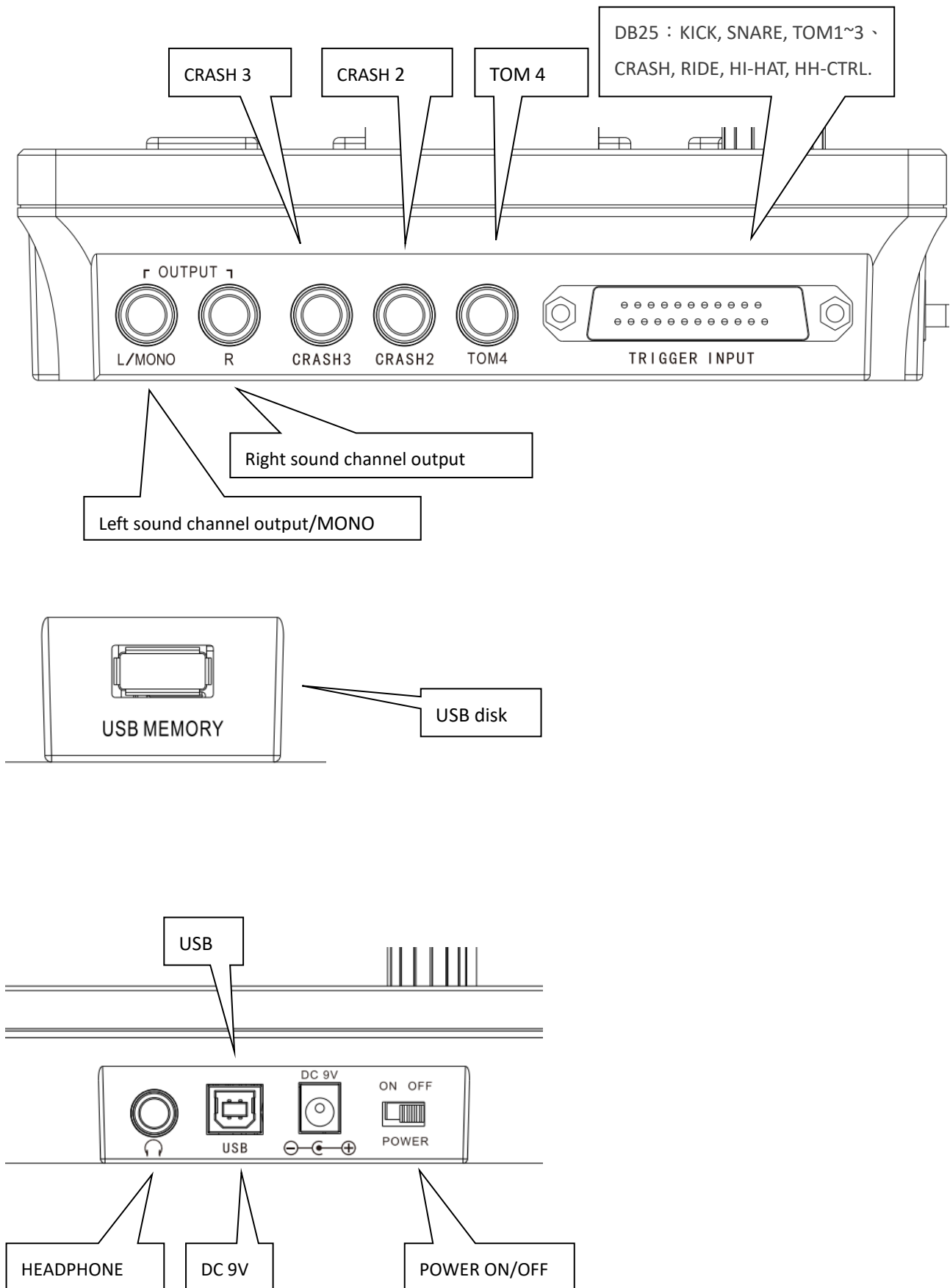

1.3. Basic settings

1.3.1. Connect drum accessories

1. Use the line to connect the drum to [TRIGGER INPUT].
2. Additional expansion [CARSH2],[CARSH3],[TOM4].

1.3.2. Connecting the power

1. Confirm the drum trigger module is turned off (no display on the display screen).
2. Plug the power cord into the jack.
3. The power supply plug into the wall outlet.
4. Turn the power switch.

1.3.3. Connect headphones or speakers

1. Connect the headset.
2. The headphone jack is inserted [].
3. Connect the speakers.
4. The speaker wire is connected to the Output of [L] and [R] jacks (standard mono audio).

1.3.4. Play the song USB disk (USB MEMORY)

1. After inserting a USB disk with MP3 or WAV songs, press the “SONG” button to automatically search all the song files.

1.3.5. USB port

1. This jack is used to connect the keyboard with the computer, send MIDI messages directly to the sound card (only drums Channel 10).

1.3.6. Restore factory settings

1. Factory reset all settings.
Before turning the first press [Edit], and then turn on the power switch.
2. The basic rhythm set to restore factory default settings.
Before turning to hold down [Kit], and then turn on the power switch.
3. Advanced Drum Set restores factory default setting.
Before turning to hold down [Mute], then turn on the power switch.

Chapter2. Basic skills

2.1. Basic operation

2.1.1. Adjust the volume

1. Turn the Volume knob to the right, you can turn up the volume.
2. Turn the Volume knob to the left, you can adjust the volume.

2.1.2. Select the Drum Kit

1. Press [Kit] button lights.
2. Note display subtitles on the screen, use the [value knob] or [+], [-] button to select the type of drum set.
3. Percussion Drum group audition type (preset drum kits 20 groups, 10 groups of user-defined).

2.2. Playing in the music accompaniment

2.2.1. Select Song

1. Press [SONG] button lights.
2. Turn the [value knob] or [+], [-] button to select the playback.
3. Press the Start / Stop button [▶/■] to play or stop demo.

2.2.2. Adjust the song volume/ tempo

1. Press the [SONG] button lights.
2. Turn the [value knob] or [+], [-] button to select the playback.
3. Then press the [Edit] button, after the lights, press [SONG] button and select Volume / Tempo option.
4. Turn the [value knob] or [+], [-] button to adjust the music volume.
5. Setup is complete then press [Edit] button, you can put out the lights.

2.2.3. Song of the drum part mute

4. Press the [SONG] button lights.
5. Turn the [value knob] or [+], [-] button to select the playback.
6. When you need to practice on their own drum music, just press [Mute] to mute the music of drums.

2.2.4. Loop playback of the song

1. Press the [SONG] button.
2. Turn the [value knob] or [+], [-] button to select the playback.
3. Press the Start / Stop button [▶/■] to play or stop demo.
4. If there is no press Stop, you can continue to single loop playback.

2.3. Play music with USB disk (USB MEMORY)

2.3.1. Support playback format

1. .MP3
2. .WAV

2.3.2. Sequence of music playing priority

1. Insert a USB disk, the USB disk has a file of .mp3 or .wav format, Press the [SONG] button, LCD display [USB song 1],[single stop].
2. Not insert a USB disk, or it is no supporting file for USB disk, Press the [SONG] button, play built-in 10 music MIDI song, LCD display[Midi song 1],[Volume:85 b=140]..
3. Then press the [Edit] button, after the lights, press [CLICK] button to select Volume /Tempo option.
4. Turn the [value knob] or [+], [-] button to adjust the tempo.
5. Setup is complete then press [Edit] button, you can put out the lights.

2.3.3. Selection of music

1. Insert a USB disk with .mp3 or .wav format.
2. Press [SONG] button to automatically read the music in USB disk (maximum support of 9999).
3. Rotation [knob], choose to play music, [+], [-] button to adjust volume.
4. Press the Start / Stop button [▶/■] to play or stop music.

2.3.4. Select play mode

1. Press [EDIT] button.
2. Press [SONG] button to select.
3. LCD display [MP3 play mode], [Single Stop], this is to say stop playing after the hit single .MP3 file.
4. Rotation [knob] or [+],[-] button,select All, Single, File,Random, Single Stop, All stop.

Repeat All : Repeat the songs in the all folders.
Repeat Single : Repeat the songs in the current folders.
Repeat File : Repeat a single song.
Random : Play the song randomly.
Single Stop : Play the song of the current folder, it will stop playing.
All Stop : After all the songs are played, stop playing.

2.3.5. Selection music mode

1. Press [EDIT] button, then press [SONG] , LCD display[MP3 EQ mode:] ,[Normal].
2. Rotation [knob] or [+], [-] button, choose Normal, POP, Rock, Jazz, Classic.

2.4. Using the metronome

2.4.1. Start and stop

1. Press [Click] button.
2. Turn the [value knob] or [+], [-] button to select the metronome.
3. Press the Start / Stop button [▶/■] to play or stop the metronome.

2.4.2. Adjust the tempo

1. Press [CLICK] button lights.
2. Turn the [value knob] or [+], [-] button to select the playback.
3. Then press the [Edit] button, after the lights, press [CLICK] button to select Volume/Tempo option.
4. Turn the [value knob] or [+], [-] button to adjust the tempo.
5. Setup is complete then press [Edit] button, you can put out the lights.

2.5. Record Performance

2.5.1. Recording

1. Press [Rec] button lights. (automatically deleted Before tracks)
2. Percussion Drum group began recording.
3. Press [Rec] button, lights off, it stops recording.

2.5.2. Playing

1. Press the [Play] button lights.
2. Started playing percussion drum set.
3. Press the [Play] button, lights off, it stops recording

Chapter3. Drum group editor

3.1. Create your own original sound group

3.1.1. Enter edit mode

1. Press [Kit] button lights.
2. Then press the [Edit] button, after the lights, enter edit mode.

3.1.2. Select Edit item

1. Use [Kit] key to select (Voice / volume / Pan / pitch / Reverb /MIDI note) item.

3.1.3. Select Edit part

1. Knock panel to select the editing position, you can also press [Record] / [Play] option.
(Kick , Snare , Tom1 , Tom2 , Tom3 , Hihat , Hihat-ctrl , Crash , Ride...)

3.1.4. Changing values

1. By rotating [value knob] or [+], [-] button, to increase its value set.

3.1.5. Storage edit

1. Press the Start / Stop button [▶/■], the screen will display the Store data to?
2. Use the [value knob] or [+], [-] key to select To set the user-defined groups (USER KIT 1 ~ 10)
3. Press the start / stop key [▶/■], the screen will display saving.....
4. The complete storage.

3.1.6. Changing values

1. Press [Edit] button lights out, exit edit mode.

Chapter4. Advanced Function Setting

4.1. Select the set

- Press the [Edit] button, after lights, press [Mute] button to select the option I want to be a set of other adjustments.(Sensitive/Trigger/Thresh/Velocity Curve/X-talk/Hi-hat splash/Reverb)
- Press [▶/■] button lights. Screen: Are you sure to Store advance?
- Press [▶/■] button lights out.
- Press [Edit] button, the lamp is off, to complete the setting.

4.2. Sensitive

- Detection sensitivity can be adjusted battering drum, each drumhead set independently.

4.3. Retrigger

- Drum speed can be adjusted to detect battering, each drumhead set independently.

4.4. Threshold

- Drum speed can be adjusted to detect battering, each drumhead set independently.

4.5. Velocity Curve

- There are four selectable velocity curves, each drumhead independent set.

1. Exp

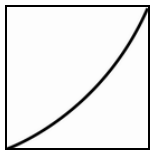

2. Log

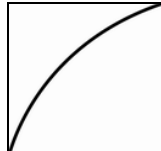

3. Loud

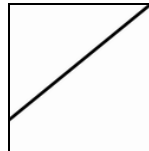

4. Linear

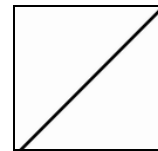

4.6. Hi-hat splash

- Exclusive adjustment "pedal cymbals" caused by water splashing on the ground similar to the natural sound effects, the more obvious the higher the value.

4.7. Reverb on/off

- All drums echo control master switch.

4.8. X-talk

- Noise interference when the X-talk larger the value, the better to prevent crosstalk.

4.9. Surround on/off

- All drums surround effect switch.

Chapter5. Reference

5.1. Inventory data

5.1.1. Drum setting

Edit + Kit(Cycle selection)	Display	Range
Press Kit Button - 1	Voice	Drum Voice list
Press Kit Button - 2	Volume	0-100
Press Kit Button - 3	Pan	L5~Center~R5
Press Kit Button - 4	Pitch	-12~0~+12
Press Kit Button - 5	Reverb	0~127
Press Kit Button - 6	Midi note	0~127

5.1.2. Click setting

Edit+ Click(Cycle selection)	Display	Range
Press Click Button - 1	Click Volume	0~100
Press Click Button - 2	Click Tempo	30~250

5.1.3. Demo setting

Edit+ Song(Cycle selection)	Display	Range
Press Song Button - 1	Snog Volume	0~100
Press Song Button - 2	Snog Tempo	30~250

5.1.4. Advanced setting

Edit+ Mute(Cycle selection)	Display	Range
Press Mute Button - 1	Sensitive	0~32
Press Mute Button - 2	Retrig	0~50
Press Mute Button - 3	Thresh	0~50
Press Mute Button - 4	Velocity Curve	1~4
Press Mute Button - 5	X-talk	0~100
Press Mute Button - 6	Hi-Hat splash	0~50
Press Mute Button - 7	Reverb	ON/OFF

5.2. Specification

Model	Type	Z12K
	Trigger	Kick,Snare,Tom1,Tom2,Tom3,Hihat,Hihat-ctrl,Crash,Ride
	Optional Expansion	Tom4, Crash2, Crash3
	Maximum polyphony	81
	Effect units	reverb
Kit	Classification	Kick, Snare, Tom, Hi-hat, Crash, Ride, percussion
	Number of voices	229
Song	Quantity	10
	Song format	MIDI
USB Disk	Number	999
	Format	.MP3 .WAV
Metronome	Tempo	30-250
	Time signatures	1-6
Audio files	Sampling format	44.1Khz/16bit PCM
Other items	Display	16x2 LCD
	Connectors	Line out, head phone, USB, DB25, Tom4, Crash2, Crush3, USB Memory

5.3. Drum Voice List

Kick PC:100 Total = 17					
1	Kick-Pop-1	2	Kick-Pop-XL	3	Kick-Metalt-1
4	Kick-Jungle-Comp-XL	5	Kick-Jungle-XL	6	Kck-Vintage-long
7	Kick-Vintage-released-Bright	8	Kick-Vintage-released-XL	9	Kick-House
10	Kick-Indie	11	Kick-Jazz	12	Kick- Metalt-2
13	Kick- Metalt-3	14	Kick- Metalt-4	15	Kick-Pop-2
16	Kick-Rock	17	Kick-Custom		
Snare PC:101 Total=41					
1	Snare-Metal-3-rods-XL	2	Snare-Metal-3-Rods-Rimshot	3	Snare-Metal-4-Open-S
4	Snare-Metal-4-RimShot	5	Snare-Jazz-1-XL	6	Snare-Jazz-1-Snappy
7	Snare-Jazz-1-z2-XL	8	Snare-Jazz-1-rimshot-full-XL	9	Snare-Brush-1-XL
10	Snare-Brush-1-Rimshot	11	Snare-Brush-2	12	Snare-Jungle-1-Rimshot-XL
13	Snare-Jungle-1-Rimshot	14	Snare-Vintage-1	15	Snare-Vintage-1-z2
16	Snare-Vintage-1-rimshot-XL	17	Snare-MetalSnare 01	18	Snare-MetalSnare Rimshot 01
19	Snare-MetalSnare 02	20	Snare-MetalSnare Rimshot 02	21	Snare-MetalSnare 03
22	Snare-MetalSnare Rimshot 03	23	Snare-PopSnare	24	Snare-PopSnare Rimshot
25	Snare-RockSnare	26	Snare-RockSnare Rimshot	27	Snare-FunkSnare 02
28	Snare-FunkSnare Rimshot 02	29	Snare-Custom_Snare3	30	Snare-Custom_Snare4
31	Snare-Custom_Snare1	32	Snare-CustomSnareRimShor1	33	Snare-IndieSnare
34	Snare-IndieSnare Rimshot	35	Snare-Std37d	36	Snare-SN_brady
37	Snare-Gretsch	38	Snare-Peral	39	Snare-Yamaha
40	Snare- Custom_Snare2	41	Snare- CustomSnareRimShor2		
Toms PC:102 Total=80					
1	Tom-Rock1-4-XL	2	Tom-Rock1-3-XL	3	Tom-Rock1-2-XL
4	Tom-Rock1-1-XL	5	Tom-Rock1-4-Rim	6	Tom-Rock1-3-Rim
7	Tom-Rock1-2-Rim	8	Tom-Rock1-1-Rim	9	Tom-Rock1-EQ-4-XL
10	Tom-Rock1-EQ-3-XL	11	Tom-Rock1-EQ-2-XL	12	Tom-Rock1-EQ-1-XL
13	Tom-Rock1-EQ-4-Rim	14	Tom-Rock1-EQ-3-Rim	15	Tom-Rock1-EQ-2-Rim
16	Tom-Rock1-EQ-1-Rim	17	Tom-Vintage1-4	18	Tom-Vintage1-3
19	Tom-Vintage1-2	20	Tom-Vintage1-1	21	Tom-Vintage1-4-Rim
22	Tom-Vintage1-3-Rim	23	Tom-Vintage1-2-Rim	24	Tom-Vintage1-1-Rim
25	Tom-Metal2-4-XL	26	Tom-Metal2-3-XL	27	Tom-Metal2-2-XL
28	Tom-Metal2-1-XL	29	Tom-Metal2-4-Rim	30	Tom-Metal2-3-Rim
31	Tom-Metal2-2-Rim	32	Tom-Metal2-1-Rim	33	Tom-Jungle1-4
34	Tom-Jungle1-3	35	Tom-Jungle1-2	36	Tom-Jungle1-1
37	Tom-Jungle1-4-Rim	38	Tom-Jungle1-3-Rim	39	Tom-Jungle1-2-Rim
40	Tom-Jungle1-1-Rim	41	IndieTom4	42	IndieTom3
43	IndieTom2	44	IndieTom1	45	IndieTom4_rim
46	IndieTom3_rim	47	IndieTom2_rim	48	IndieTom1_rim

49	JazzTom4	50	JazzTom3	51	JazzTom2
52	JazzTom1	53	JazzTom4_rim	54	JazzTom3_rim
55	JazzTom2_rim	56	JazzTom1_rim	57	MetalTom4
58	MetalTom3	59	MetalTom2	60	MetalTom1
61	MetalTom4_rim	62	MetalTom3_rim	63	MetalTom2_rim
64	MetalTom1_rim	65	PopTom4	66	PopTom3
67	PopTom2	68	PopTom1	69	PopTom4_rim
70	PopTom3_rim	71	PopTom2_rim	72	PopTom1_rim
73	Custom_Btt	74	Custom_Ftt	75	Custom_Mtt
76	Custom_Htt	77	Custom_BttRim	78	Custom_FttRim
79	Custom_MttRim	80	Custom_HttRim		
HiHat PC:103 Total=44					
1	HH_Classic_14_Shoulder_OpenX	2	HH_Classic_14_Shoulder_HalfOp3X	3	HH_Classic_14_Shoulder_Closed2X
4	HH_Classic_14_TchickX	5	HH-Rock-Top-open	6	HH-Rock-Top-half4
7	HH-Rock-Top-closed	8	HH-Rock-chick	9	HH-Brush-1-open
10	HH-Brush-1-half3	11	HH-Brush-1-chick	12	HH-Brush-1-chick
13	HH-Vintage-Top-open	14	HH-Vintage-Top-Half2	15	HH-Vintage-Top-closed
16	HH-Vintage-chick	17	HH-Electro8-open	18	HH-Electro8-Half3
19	HH-Electro8-closed	20	HH-Electro8-chick	21	IndieHH Open Top
22	IndieHH 1_2 Open Top	23	IndieHH Closed Top	24	IndieHH Pedal
25	JazzHH Open Top	26	JazzHH 1_2 Open Top	27	JazzHH Closed Top
28	JazzHH Pedal	29	RockHH Open Top	30	RockHH 1_2 Open Top
31	RockHH Closed Top	32	RockHH Pedal	33	Custom_HihatOpenTip1
34	Custom_Hihat1_2OpenTip1	35	Custom_HihatCloseTip1	36	Custom_HihatOpenPedal1
37	RockCrash2 Top	38	RockSplash	39	TranceCrash1
40	TranceCrash2	41	TrapCrash1 01	42	Custom_CrashEdge1
43	Custom_CrashBow1	44	Std57d_crash2		
Crash PC:104 Total=36					
1	Crash_Classic_CHB_H_Edge	2	Crash_Classic_CHB_H_Shoulder	3	Crash_Rock-V20-Edge
4	Crash_Rock-V20-Shoulder	5	Crash-Rock-1-edge-XL	6	Crash-Rock-2-edge
7	China-Metal-1	8	China-Metal-1-XL	9	Crash-Metal-2-edge
10	Crash-Jungle-1-edge	11	Crash-Jungle-3-edge	12	Crash-Jungle-4-splash-hi
13	Crash-Jungle-4-splash-hi2	14	Crash-Jungle-5-splash-muted	15	Crash-Jungle-5-splash-muted-XL
16	Crash-Jungle-6-splash-side	17	Crash-Vintage-1-edge	18	Crash-Vintage-2-edge
19	Crash-Vintage-3-edge	20	FunkCrash1 01	21	FunkCrash1 02
22	FunkCrash2 01	23	FunkCrash2 02	24	IndieCrash1 01
25	IndieCrash1 02	26	IndieCrash2 01	27	IndieCrash2 02
28	JazzCrash2 Top	29	JazzSplash 01	30	JazzSplash 02
31	PopChina	32	PopCrash	33	RockChina
34	RockCrash1 Edge	35	RockCrash1 Top	36	RockCrash2 Edge
Ride PC:105 Total=34					

1	Ride_Rock-ping24-Bell	2	Ride_Rock-ping24-Shoulder	3	Ride_Rock-ping24-Edge
4	Ride_Rock-ping24-VeloBell	5	Ride_Dark_20_Edge	6	Ride-Rock-1-bell
7	Ride-Jazz-1-bell	8	Ride-Jazz-1-top	9	Ride-Jazz-2-bell
10	Ride-Jazz-2-top2	11	Ride-Brush-1-bell-XL	12	Ride-Brush-2-bell
13	Ride-Jungle-1-bell	14	Ride-Vintage-1-Bell	15	Ride-Vintage-1-shoulder
16	Ride-Fiesta-1-top	17	Ride-Metal-1-bell	18	Ride-Metal-1-shoulder
19	FunkRide Bell 02	20	FunkRide Edge 02	21	IndieRide Edge
22	MetalRide Bell	23	MetalRide Edge	24	MetalRide Top
25	PopRide Bell	26	PopRide Edge	27	PopRide Top
28	RockRide Bell	29	RockRide Edge	30	RockRide Top
31	Custom_RideEdge1	32	Custom_RideBow1	33	Std51NEW_ride1
34	Std59NEW_ride2				
Perc PC:106 Total=33					
1	ma808	2	mcg808	3	Std54d
4	Std56d	5	Std58d	6	Std60d
7	Std61d	8	Std62d	9	Std63d
10	Std64d	11	Std65d	12	Std66d
13	Std67d	14	Std68d	15	Std69d
16	Std70d	17	Std71d	18	Std72d
19	Std73d	20	Std74d	21	Std75d
22	Std76d	23	Std77d	24	Std78new
25	Std79new	26	Std80d	27	Std81d
28	Std82d	29	Std83d	30	Std84d
31	Std85d	32	Std86d	33	Std87d

Chapter6. Appendix



6.1. Drum kit assembly



Stand



Kick rod x1



Cymbal mounts x3



Pad rod x4



Drum sticks



Wire clamp



Snare



Tom x4



Ride



Cymbal x3



Kick drum



H.H Ctrl



H.H Ctrl controller



Kick pedal



Snare rod

STAND



Adjust the position simply loosen two screws



Distance \leq 1.3m (Less than 1.3m)

1. Install Kick drum pedal and step on the hammer.
2. L-strut insert drum plate bracket deck.
3. Finally, the Cha piece strut stent insertion clips

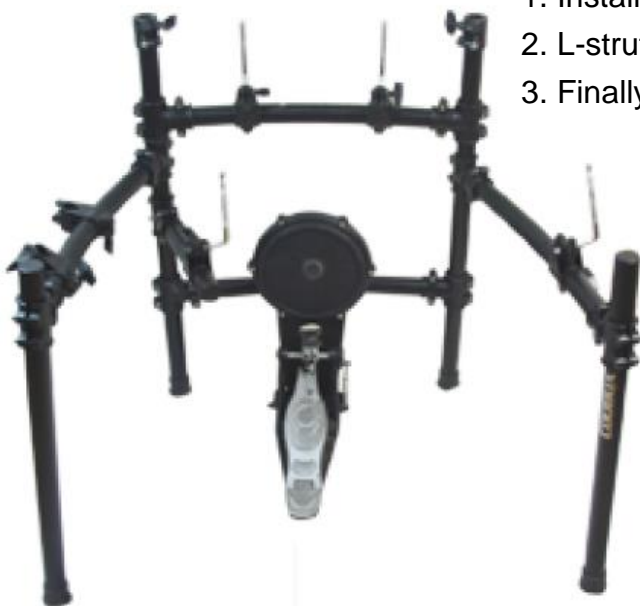

the bolt

Use black nut to adjust the position.
Strut toward the direction of the player.

KICK

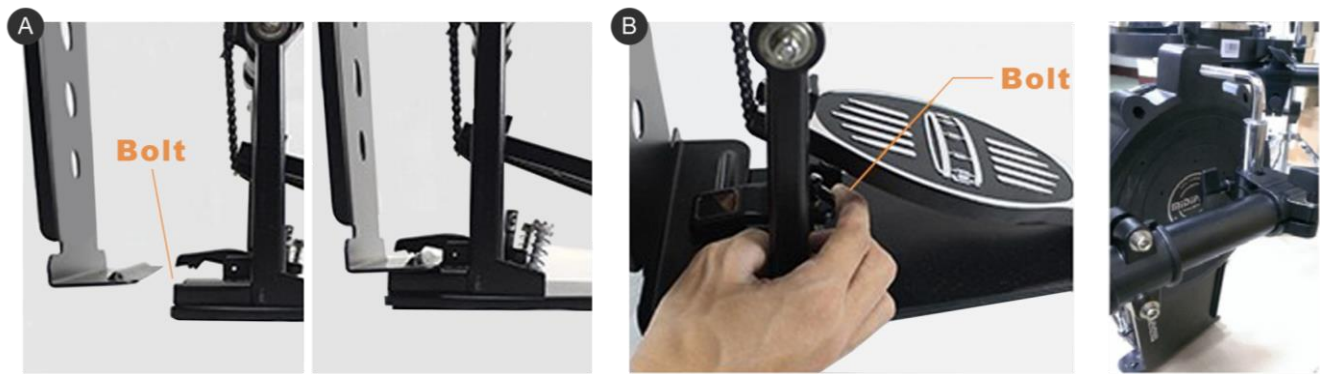

CYMBAL/RIDE

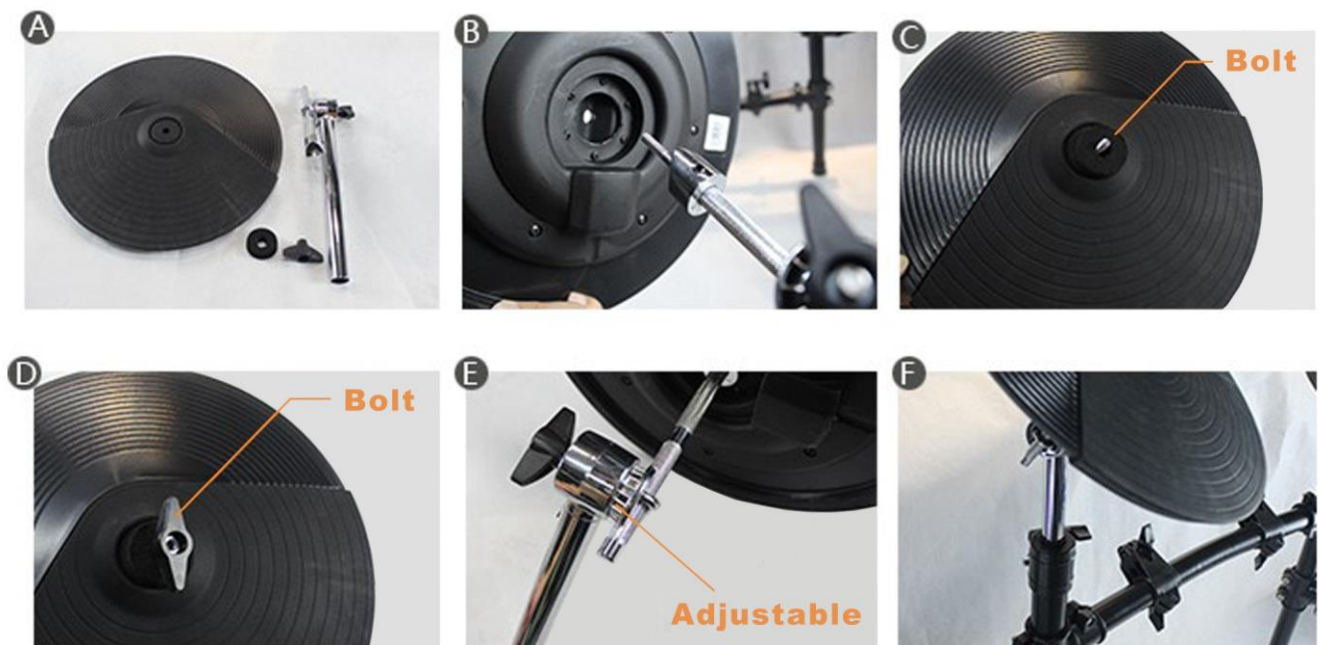

SNARE

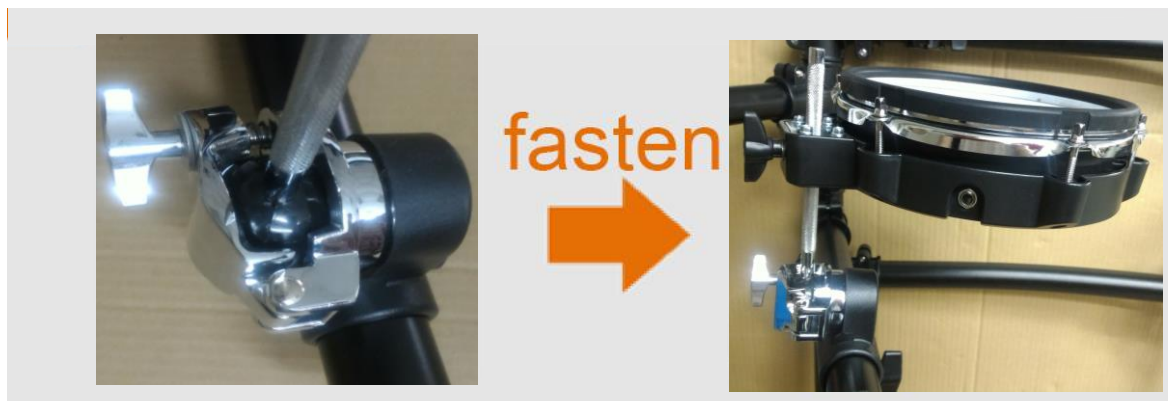

TOM

A.



B.



C.



D.



H.H.-CTRL

A.



B.

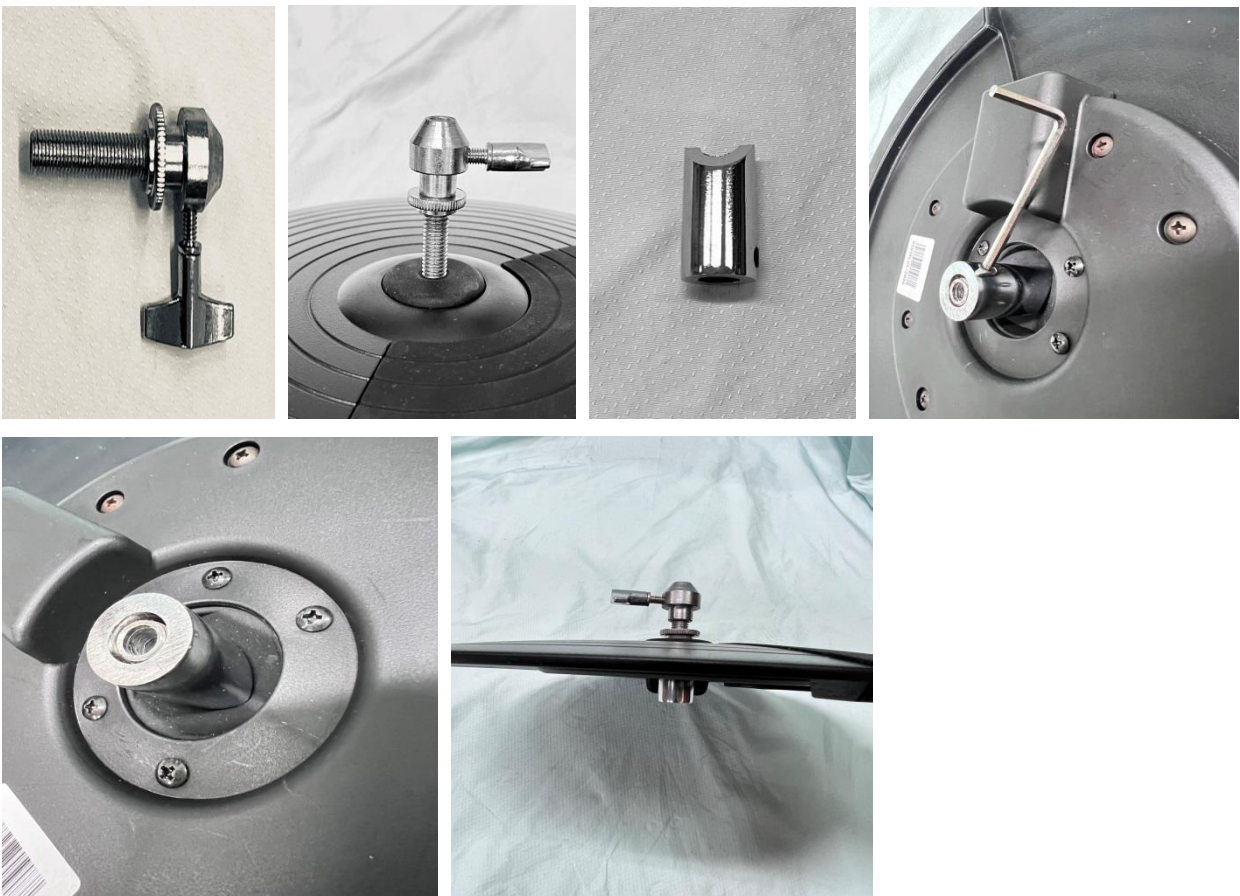

C.



6.2. Control box assembly



Z12K come with adaptor and cable DB25



Screw X 3



model rod X1

ASSEMBLY

The back of the control box has three screw holes aligned holes lever control box, screw lock



Control box assembly to the bracket, lock can be fixed, then the audio cable into the corresponding socket.

