

# MIDIPLUS

## ED9pro Owner's Manual



# CONTENTS

|   |   |
|---|---|
| Preface.....                                    | 1 |
| What's in the Box?.....                         | 1 |
| ED9pro Overview .....                           | 1 |
| Caution.....                                    | 1 |
| Chapter1. Setup.....                            | 2 |
| 1.1. Quick Start .....                          | 2 |
| 1.1.1. Choosing Drum Sounds .....               | 2 |
| 1.1.2. Playing Along with a Song or MP3 .....   | 2 |
| 1.1.3. Practicing with the Metronome.....       | 2 |
| 1.1.4. Recording Your Performances .....        | 2 |
| 1.1.5. Playing Your Performances.....           | 2 |
| 1.1.6. Snare Rim shot/Cross stick .....         | 2 |
| 1.2. Overview .....                             | 3 |
| 1.2.1. Front Panel .....                        | 3 |
| 1.2.2. Rear Panel .....                         | 4 |
| 1.3. Basic settings.....                        | 5 |
| 1.3.1. Connect drum accessories .....           | 5 |
| 1.3.2. Connect headphones or speakers .....     | 5 |
| 1.3.3. Play the song USB disk(USB MEMORY) ..... | 5 |
| 1.3.4. USB port .....                           | 5 |
| 1.3.5. Restore factory settings .....           | 5 |
| Chapter2. Basic skills .....                    | 6 |
| 2.1. Basic operation.....                       | 6 |
| 2.1.1. Adjust the volume .....                  | 6 |
| 2.1.2. Select the Drum Kit.....                 | 6 |
| 2.2. Playing in the music accompaniment.....    | 6 |
| 2.2.1. Select Song.....                         | 6 |
| 2.2.2. Adjust the song volume/ tempo .....      | 6 |
| 2.2.3. Song of the drum part mute.....          | 6 |
| 2.2.4. Loop playback of the song .....          | 6 |
| 2.3. Play music with USB disk(USB MEMORY) ..... | 7 |
| 2.3.1. Support playback format .....            | 7 |
| 2.3.2. Sequence of music playing priority ..... | 7 |
| 2.3.3. Selection of music .....                 | 7 |
| 2.3.4. Select play mode .....                   | 7 |
| 2.3.5. Selection music mode .....               | 7 |
| 2.4. Using the metronome .....                  | 8 |
| 2.4.1. Start and stop.....                      | 8 |

|           |   |    |
|-----------|---|----|
| 2.4.2.    | Adjust the tempo .....                    | 8  |
| 2.5.      | Record Performance.....                   | 8  |
| 2.5.1.    | Recording .....                           | 8  |
| 2.5.2.    | Playing .....                             | 8  |
| Chapter3. | Drum group editor.....                    | 9  |
| 3.1.      | Create your own original sound group..... | 9  |
| 3.1.1.    | Enter edit mode .....                     | 9  |
| 3.1.2.    | Select Edit item .....                    | 9  |
| 3.1.3.    | Select Edit part .....                    | 9  |
| 3.1.4.    | Changing values .....                     | 9  |
| 3.1.5.    | Storage edit .....                        | 9  |
| 3.1.6.    | Changing values .....                     | 9  |
| Chapter4. | Advanced Function Setting.....            | 10 |
| 4.1.      | Select the set.....                       | 10 |
| 4.2.      | Sensitive .....                           | 10 |
| 4.3.      | Retrig.....                               | 10 |
| 4.4.      | Thresh.....                               | 10 |
| 4.5.      | Velocity Curve.....                       | 10 |
| 4.6.      | X-talk .....                              | 10 |
| 4.1.      | Hi-hat splash .....                       | 10 |
| 4.2.      | Reverb on/off .....                       | 10 |
| Chapter5. | Reference .....                           | 11 |
| 5.1.      | Inventory data .....                      | 11 |
| 5.1.1.    | Drum setting.....                         | 11 |
| 5.1.2.    | Click setting .....                       | 11 |
| 5.1.3.    | Demo setting .....                        | 11 |
| 5.1.4.    | Advanced setting.....                     | 12 |
| 5.2.      | Specification.....                        | 12 |
| 5.3.      | Drum Voice List .....                     | 13 |
| Chapter6. | Appendix .....                            | 20 |
| 6.1.      | Drum kit assembly .....                   | 21 |
| 6.2.      | Control box assembly.....                 | 25 |

# Preface

Thank you for buying a ED9pro electronic drums, MIDIPLUS company with the most simple and convenient setting operation mode to make it easier for beginners handy target, please read the instruction manual before use.

## What's in the Box?

Included in the **MIDIPLUS ED9pro** package, you should find:

- One (1) e-drum control Box (Z11 Pro BT)
- One (1) owner's manual
- One (1) 9V DC power adaptor
- One (1) drum stand (attached assembly diagram).
- One (1) package blow kit accessories.

## ED9pro Overview

The following is provided by the electronic drum ED9pro features:

- Built 33 group preset drum kits, 20 user groups may edit drum set, using a true multiple-sampled drum lossless studio recording drums.
- Built-in metronome, 10 demo songs and easy listening learning fast recording function.
- Crash cymbals, support double trigger, cymbals face, cymbals edge and stop tones.
- Ride cymbals, support 3 triggered cymbals face, cymbals heart, cymbal edge and stop tones.
- Pedal cymbals (hi-hat) support closed, semi-open, open, Pedal hi-hat, Foot splash and stop tones.
- Special material multilayer woven mesh drum skin can best simulate real drums crackdown and feel, support dual trigger.
- Kick (Bass drum) and drum kits use a fixed link bracket, firmly positioning drum hit hard step.
- Snare rim can quickly switch Cross-stick, Rim-shot sound.
- Scalable two Crash cymbals (Crash2) and (Crash3), a fourth Tom drum (Tom4).
- Support USB disk MP3, WAV.

## Caution

- Do not place the power cord near heat sources such as heaters or radiators. Also, do not excessively bend or otherwise damage the cord, or place heavy objects on it.
- Only use the voltage specified as correct for the instrument. The required voltage is printed on the name plate of the instrument.
- Use the specified adaptor only. Using the wrong adaptor can result in damage to the instrument or overheating.
- Check the electric plug periodically and remove any dirt or dust which may have accumulated on it.
- Never insert or remove an electric plug with wet hands.
- Do not open the instrument or attempt to disassemble or modify the internal components in any way

# Chapter1. Setup

## 1.1. Quick Start

### 1.1.1. Choosing Drum Sounds

1. Press the [Kit] button.
2. Note display subtitles on the screen, use the [value knob] or [+], [-] button to select the type of drum set.
3. Listen percussion drum set type (preset drum kits 20 groups, 10 user-defined groups).

### 1.1.2. Playing Along with a Song or MP3

1. Not insert a USB disk, or it is no supporting file for USB disk, Press the [SONG] button, play built-in 10 music MIDI song ,LCD display[Midi song 1],[Volume:85 b=140].
2. Insert USB disk, USB disk with MP3 or WAV file, press [Song] button to play the USB disk song files, the LCD display [USB song: 1], [single stop].
3. Turn the [value knob] or [+], [-] button to select the playback.
4. Press the start / stop button [ ▶/■ ] to play or stop demo.

### 1.1.3. Practicing with the Metronome

1. Press the [Click] button.
2. Turn the [value knob] or [+], [-] button to select the tempo.
3. Press the start / stop button [ ▶/■ ] to play or stop tempo.

### 1.1.4. Recording Your Performances

1. Press the [Rec] button.
2. When the lights begin recording.
3. Then click the [Rec] button.
4. After the lights off to stop recording.

### 1.1.5. Playing Your Performances

1. Press the [Play] button.
2. When the lights begin playing.
3. Then click the [Play] button.
4. After the lights off to stop playing.

### 1.1.6. Snare Rim shot/Cross stick

1. Press the [Kit] button. Press the [Mute] button to display the top right corner of the screen displays the CS (cross stick).
2. Then click the [Mute] button, CS disappear (rim shot).

## 1.2. Overview

### 1.2.1. Front Panel

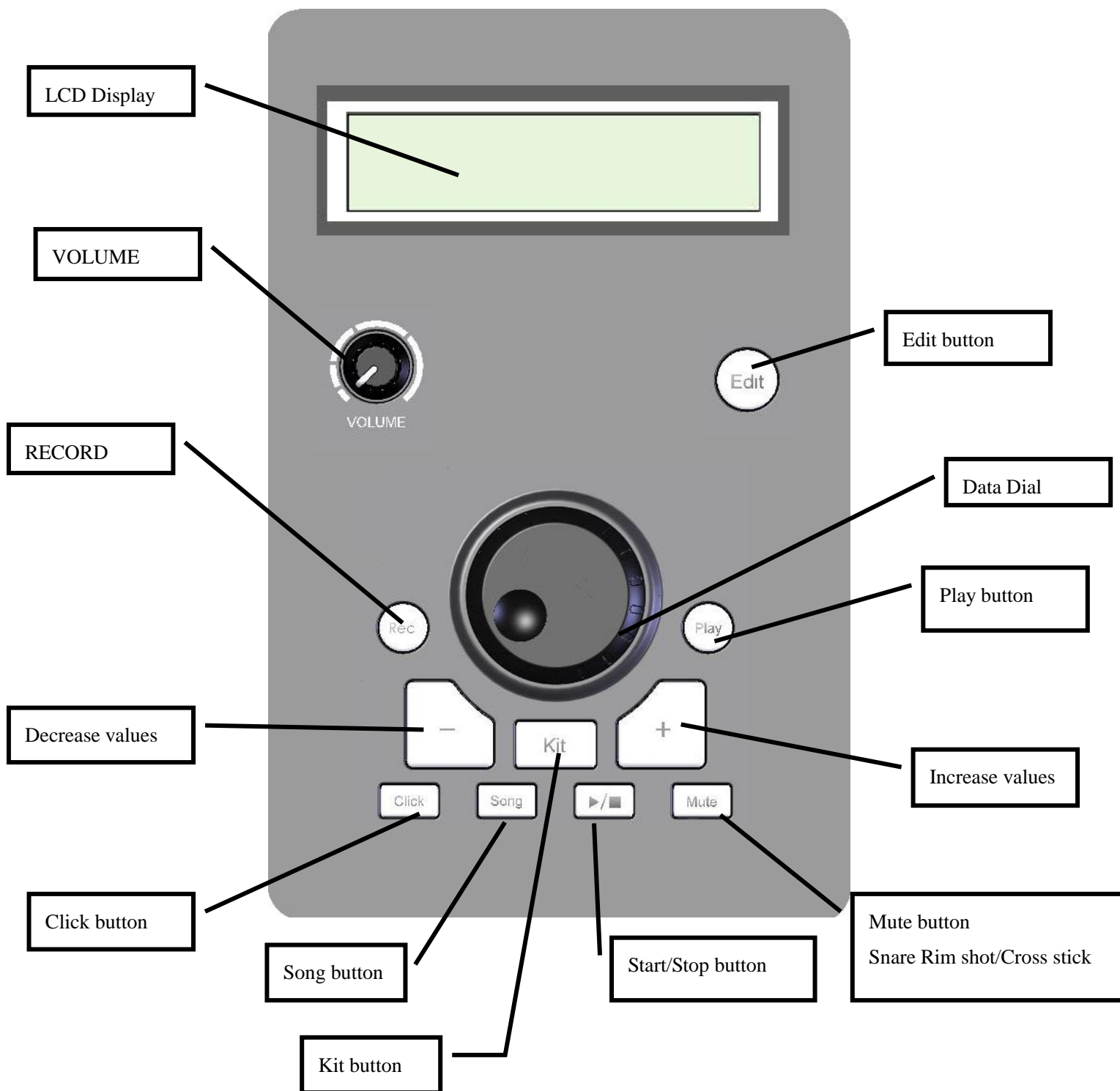

## 1.2.2. Rear Panel

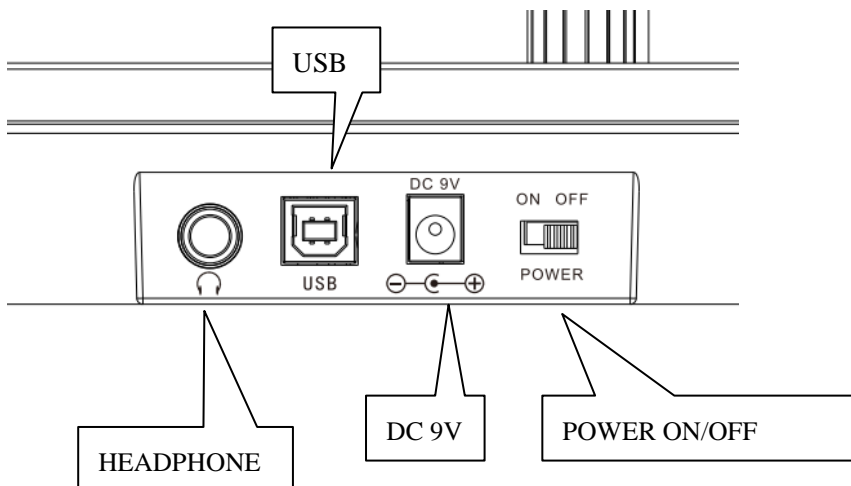
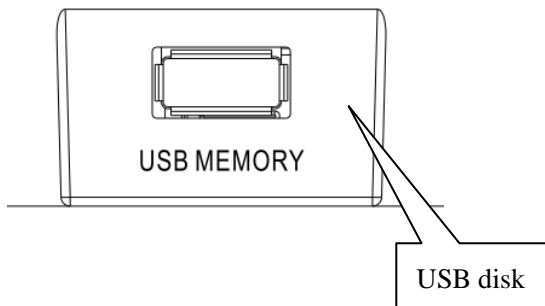
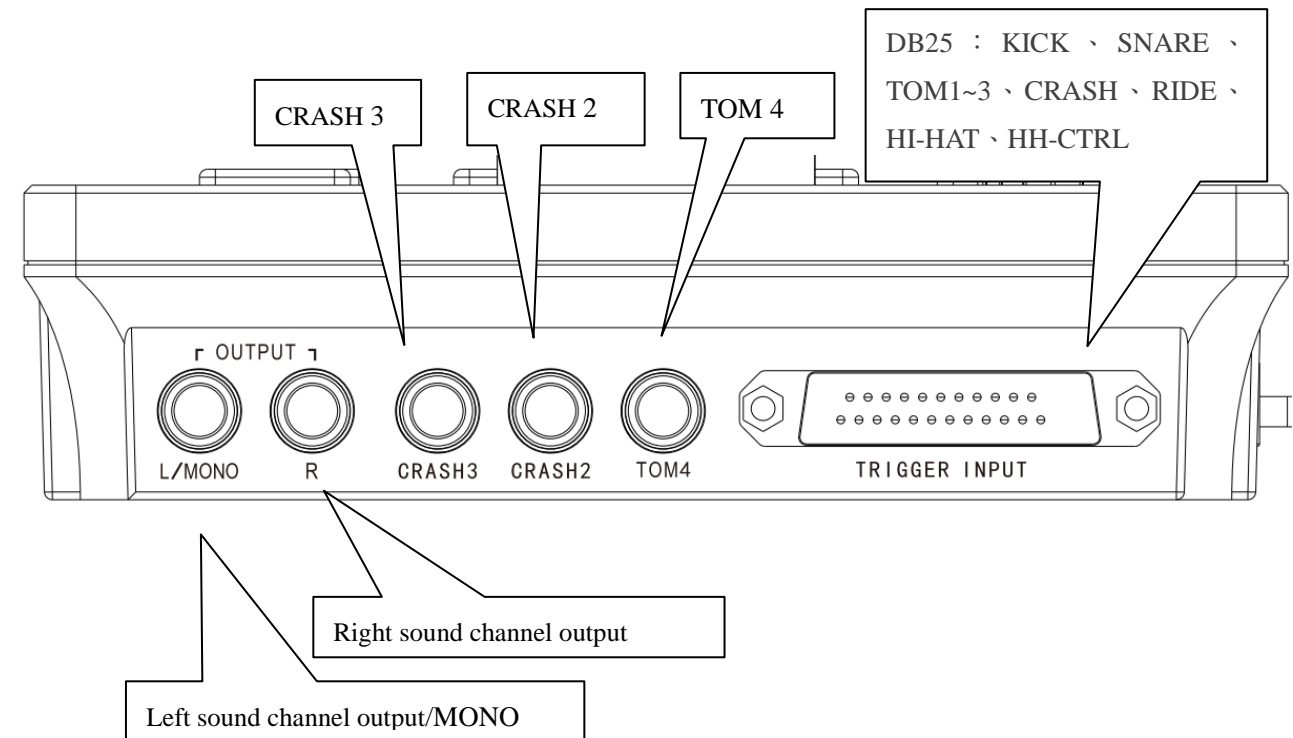

## 1.3. Basic settings

### 1.3.1. Connect drum accessories

1. Use the line to connect the drum to [TRIGGER INPUT].
2. Additional expansion [CARSH2],[CARSH3],[TOM4].

### 1.3.2. Connect headphones or speakers

1. Connect the headset.  
The headphone jack is inserted [ ].
2. Connect the speakers.  
The speaker wire is connected to the Output of [L] and [R] jacks (standard mono audio).

### 1.3.3. Play the song USB disk(USB MEMORY)

After inserting a USB disk with MP3 or WAV songs, press the “SONG” button to automatically search all the song files.

### 1.3.4. USB port

This jack is used to connect the keyboard with the computer, send MIDI messages directly to the sound card (only drums Channel 10).

### 1.3.5. Restore factory settings

3. Factory reset all settings.  
Before turning the first press [Edit], and then turn on the power switch.
4. The basic rhythm set to restore factory default settings.  
Before turning to hold down [Kit], and then turn on the power switch.
5. Advanced Drum Set restores factory default setting.  
Before turning to hold down [Mute], then turn on the power switch.

# Chapter2. Basic skills

## 2.1. Basic operation

### 2.1.1. Adjust the volume

1. Turn the Volume knob to the right, you can turn up the volume.
2. Turn the Volume knob to the left, you can adjust the volume.

### 2.1.2. Select the Drum Kit

1. Press [Kit] button lights.
2. Note display subtitles on the screen, use the [value knob] or [+], [-] button to select the type of drum set.
3. Percussion Drum group audition type (preset drum kits 20 groups, 10 groups of user-defined).

## 2.2. Playing in the music accompaniment

### 2.2.1. Select Song

1. Press [SONG] button lights.
2. Turn the [value knob] or [+], [-] button to select the playback.
3. Press the Start / Stop button [▶/■] to play or stop demo.

### 2.2.2. Adjust the song volume/ tempo

1. Press the [SONG] button lights.
2. Turn the [value knob] or [+], [-] button to select the playback.
3. Then press the [Edit] button, after the lights, press [SONG] button and select Volume / Tempo option.
4. Turn the [value knob] or [+], [-] button to adjust the music volume.
5. Setup is complete then press [Edit] button, you can put out the lights.

### 2.2.3. Song of the drum part mute

1. Press the [SONG] button lights.
2. Turn the [value knob] or [+], [-] button to select the playback.
3. When you need to practice on their own drum music, just press [Mute] to mute the music of drums.

### 2.2.4. Loop playback of the song

1. Press the [SONG] button.
2. Turn the [value knob] or [+], [-] button to select the playback.
3. Press the Start / Stop button [▶/■] to play or stop demo.
4. If there is no press Stop, you can continue to single loop playback.

## 2.3. Play music with USB disk(USB MEMORY)

### 2.3.1. Support playback format

1. .MP3
2. .WAV

### 2.3.2. Sequence of music playing priority

1. Insert a USB disk, the USB disk has a file of .mp3 or .wav format, Press the [SONG] button, LCD display[USB song 1],[single stop].
2. Not insert a USB disk, or it is no supporting file for USB disk, Press the [SONG] button, play built-in 10 music MIDI song, LCD display[Midi song 1],[Volume:85 b=140]..
3. Then press the [Edit] button, after the lights, press [CLICK] button to select Volume /Tempo option.
4. Turn the [value knob] or [+], [-] button to adjust the tempo.
5. Setup is complete then press [Edit] button, you can put out the lights.

### 2.3.3. Selection of music

1. Insert a USB disk with .mp3 or .wav format.
2. Press [SONG] button to automatically read the music in USB disk (maximum support of 9999).
3. Rotation [knob] or [+], [-] button, choose to play music.
4. Press the Start / Stop button [▶/■] to play or stop music.

### 2.3.4. Select play mode

1. Press [EDIT] button.
2. Press [SONG] button to select.
3. LCD display [MP3 play mode], [Single Stop], this is to say stop playing after the hit single .MP3 file.
4. Rotation [knob] or [+],[ -] button,select All, Single, File,Random, Single Stop, All stop.

|  |
|--|
| Repeat All : Repeat the songs in the all folders.                        |
| Repeat Single : Repeat the songs in the current folders.                 |
| Repeat File : Repeat a single song.                                      |
| Random : Play the song randomly.   |
| Single Stop : Play the song of the current folder, it will stop playing. |
| All Stop : After all the songs are played, stop playing.                 |

### 2.3.5. Selection music mode

1. Press [EDIT] button, then press [SONG] , LCD display[MP3 EQ mode:] ,[Normal].
2. Rotation [knob] or [+], [-] button, choose Normal, POP, Rock, Jazz, Classic.

## 2.4. Using the metronome

### 2.4.1. Start and stop

1. Press [Click] button.
2. Turn the [value knob] or [+], [-] button to select the metronome.
3. Press the Start / Stop button [ ▶/■ ] to play or stop the metronome.

### 2.4.2. Adjust the tempo

1. Press [CLICK] button lights.
2. Turn the [value knob] or [+], [-] button to select the playback.
3. Then press the [Edit] button, after the lights, press [CLICK] button to select Volume /Tempo option.
4. Turn the [value knob] or [+], [-] button to adjust the tempo.
5. Setup is complete then press [Edit] button, you can put out the lights.

## 2.5. Record Performance

### 2.5.1. Recording

1. Press [Record]button lights. (automatically deleted Before tracks)
2. Percussion Drum group began recording.
3. Press [Record]button, lights off, it stops recording.

### 2.5.2. Playing

1. Press the [Play] button lights.
2. Started playing percussion drum set.

Press the [Play] button, lights off, it stops recording

# Chapter3. Drum group editor

## 3.1. Create your own original sound group

### 3.1.1. Enter edit mode

1. Press [Kit] button lights.
2. Then press the [Edit] button, after the lights, enter edit mode.

### 3.1.2. Select Edit item

Use [Kit] key to select (Voice / volume / Pan / pitch / Reverb /MIDI note) item.

### 3.1.3. Select Edit part

Knock panel to select the editing position, you can also press [Record] / [Play] option.  
(Kick , Snare , Tom1 , Tom2 , Tom3 , Hihat , Hihat-ctrl , Crash , Ride...)

### 3.1.4. Changing values

By rotating [value knob] or [+], [-] button, to increase its value set.

### 3.1.5. Storage edit

4. Press the Start / Stop button [ ▶/■ ], the screen will display the Store data to?
5. Use the [value knob] or [+], [-] key to select To set the user-defined groups (USER KIT 1 ~ 10)
6. Press the start / stop key [ ▶/■ ], the screen will display saving.....
7. The complete storage.

### 3.1.6. Changing values

Press [Edit] button lights out, exit edit mode.

# Chapter4. Advanced Function Setting

## 4.1. Select the set

- Press the [Edit] button, after lights, press [Mute] button to select the option I want to be a set of other adjustments.(Sensitive/Trigger/Thresh/Velosity Curve/X-talk/Hi-hat splash/Reverb)
- Press [▶/■] button lights. Screen: Are you sure to Store advance?
- Press [▶/■] button lights out.
- Press [Edit] button, the lamp is off, to complete the setting.

## 4.2. Sensitive

- Detection sensitivity can be adjusted batting drum, each drumhead set independently.

## 4.3. Retrig

- Drum speed can be adjusted to detect batter batting, each drumhead set independently.

## 4.4. Thresh

- Drum speed can be adjusted to detect batter batting, each drumhead set independently.

## 4.5. Velocity Curve

- There are four selectable velocity curves, each drumhead independent set.

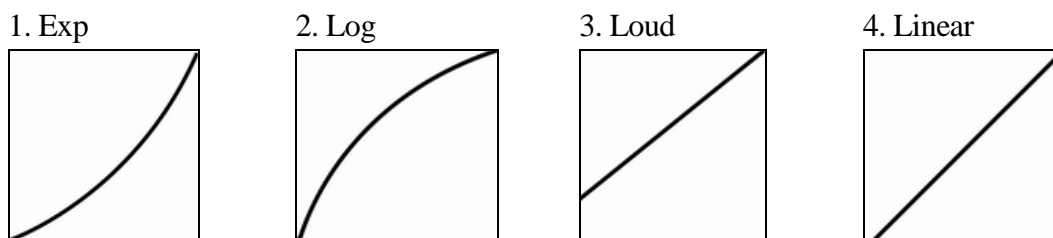

## 4.6. X-talk

- Noise interference when the X-talk larger the value, the better to prevent crosstalk.

## 4.1. Hi-hat splash

- Exclusive adjustment "pedal cymbals" caused by water splashing on the ground similar to the natural sound effects, the more obvious the higher the value.

## 4.2. Reverb on/off

- All drums echo control master switch.

# Chapter5. Reference

## 5.1. Inventory data

### 5.1.1. Drum setting

| Edit + Kit(Cycle selection) | Display   | Range           |
|-----------------------------|-----------|-----------------|
| Press Kit Button - 1        | Voice     | Drum Voice list |
| Press Kit Button - 2        | Volume    | 0-100           |
| Press Kit Button - 3        | Pan       | L5~Center~R5    |
| Press Kit Button - 4        | Pitch     | -12~0~+12       |
| Press Kit Button - 5        | Reverb    | 0~127           |
| Press Kit Button - 6        | Midi note | 0~127           |

### 5.1.2. Click setting

| Edit+ Click(Cycle selection) | Display      | Range  |
|------------------------------|--------------|--------|
| Press Click Button - 1       | Click Volume | 0~100  |
| Press Click Button - 2       | Click Tempo  | 30~250 |

### 5.1.3. Demo setting

| Edit+ Song(Cycle selection) | Display     | Range  |
|-----------------------------|-------------|--------|
| Press Song Button - 1       | Snog Volume | 0~100  |
| Press Song Button - 2       | Snog Tempo  | 30~250 |

### 5.1.4. Advanced setting

| Edit+ Mute(Cycle selection) | Display        | Range  |
|-----------------------------|----------------|--------|
| Press Mute Button - 1       | Sensitive      | 0~32   |
| Press Mute Button - 2       | Retrig         | 0~50   |
| Press Mute Button - 3       | Thresh         | 0~50   |
| Press Mute Button - 4       | Velocity Curve | 1~4    |
| Press Mute Button - 5       | X-talk         | 0~100  |
| Press Mute Button - 6       | Hi-Hat splash  | 0~50   |
| Press Mute Button - 7       | Reverb         | ON/OFF |

## 5.2. Specification

|             |                    |  |
|-------------|--------------------|--|
| Model       | Type               | Z11 Pro BT   |
|             | Trigger            | Kick,Snare,Tom1,Tom2,Tom3,Hihat,Hihat-ctrl, Crash,Ride           |
|             | Optional Expansion | Crash2, Crash3, Tom4   |
|             | Maximum polyphony  | 64   |
|             | Effect units       | reverb   |
| Kit         | Classification     | Kick, Snare, Tom, Hi-hat, Crash, Ride, percussion                |
|             | Number of voices   | 490  |
| Song        | Quantity           | 10   |
|             | Song format        | MIDI   |
| USB Disk    | Number             | 999  |
|             | Format             | .MP3, .WAV   |
| Metronome   | Tempo              | 30-250   |
|             | Time signatures    | 1-6  |
| Audio files | Sampling format    | 44.1Khz/16bit PCM  |
| Other items | Display            | 16x2 LCD   |
|             | Connectors         | line out, head phone, USB, DB25, Tom4, Crash2, Crash3, USBMEMORY |

### 5.3. Drum Voice List

| <b>Kick PC:100 Total = 82</b> |                                  |    |                            |    |                                |
|-------------------------------|----------------------------------|----|----------------------------|----|--------------------------------|
| 1                             | Kick-Rock-1                      | 2  | Kick-Rock-2                | 3  | Kick-Pop-1-bright              |
| 4                             | Kick-Pop-1-medium                | 5  | Kick-Pop-1-Soft            | 6  | Kck-Pop-1-XL                   |
| 7                             | Kick-Pop-2                       | 8  | Kick-Pop-3-bright          | 9  | Kick-Pop-3-Medium              |
| 10                            | Kick-Pop-3-Soft                  | 11 | Kick-Pop-3-XL              | 12 | Kick-Pop-4-Bright              |
| 13                            | Kick-Pop-4-Deep                  | 14 | Kick-Pop-4-Soft            | 15 | Kick-Pop-4-XL                  |
| 16                            | Kick-Pop-5                       | 17 | Kick-Metal-1-Bright        | 18 | Kick-Metal-1-Deep              |
| 19                            | Kick-Metal-1-Medium              | 20 | Kick-Metal-1-XL            | 21 | Kick-Metal-2                   |
| 22                            | Kick-Metal-2-Dry                 | 23 | Kick-Metal-2-L             | 24 | Kick-Metal-2-XL                |
| 25                            | Kick-Jazz-1-Bright               | 26 | Kick-Jazz-1-Deep           | 27 | Kick-Jazz-1-Soft               |
| 28                            | Kick-Jazz-1-XL                   | 29 | Kick-Jungle-1              | 30 | Kick-Jungle-2-Bright           |
| 31                            | Kick-Jungle-2-Comp               | 32 | Kick-Jungle-2-Comp-Bright  | 33 | Kick-Jungle-2-Comp-Medium      |
| 34                            | Kick-Jungle-2-Comp-XL            | 35 | Kick-Jungle-2-Medium       | 36 | Kick-Jungle-2-XL               |
| 37                            | Kick-Jungle-3-Bright             | 38 | Kick-Jungle-3-Deep         | 39 | Kick-Jungle-3-Medium           |
| 40                            | Kick-Jungle-3-XL                 | 41 | Kick-Vintage-1-long        | 42 | Kick-Vintage-2-released-Bright |
| 43                            | Kick-Vintage-2-released-Medium   | 44 | Kick-Vintage-2-released-XL | 45 | Kick-Vintage-3-stuck-Bright    |
| 46                            | Kick-Vintage-3-stuck-Bright-Comp | 47 | Kick-Vintage-3-stuck-Deep  | 48 | Kick-Vintage-3-stuck-Medium    |
| 49                            | Kick-Vintage-3-stuck-XL          | 50 | Kick-Electro8-1            | 51 | Kick-Electro8-Long             |
| 52                            | Kick-Electro8-Long-Soft          | 53 | Kick-Electro8-2            | 54 | Kick-Electro8-Short            |
| 55                            | Kick-Electro9-1                  | 56 | Kick-Electro9-1L           | 57 | Kick-Electro9-1V               |
| 58                            | Kick-Electro9-2                  | 59 | Kick-Electro9-2L           | 60 | Kick-Electro9-2V               |
| 61                            | Kick-Electro5-1                  | 62 | Kick-Electro5-deep         | 63 | Kick-Electro5-short            |
| 64                            | Kick-Electro5-V                  | 65 | FunkKick 02                | 66 | HouseKick 02                   |
| 67                            | IndieKick 01                     | 68 | IndieKick 02               | 69 | JazzKick                       |
| 70                            | MetalKick 01                     | 71 | MetalKick 02               | 72 | MetalKick 03                   |
| 73                            | MetalKick 04                     | 74 | PopKick                    | 75 | RockKick                       |
| 76                            | TechnoKick 04                    | 77 | TranceKick 02              | 78 | TranceKick 03                  |
| 79                            | TranceKick 04                    | 80 | TranceKick 05              | 81 | Custom_Kick2                   |
| 82                            | Custom_Kick1                     |    |                            |    |                                |
| <b>Snare PC:101 Total=125</b> |                                  |    |                            |    |                                |
| 1                             | Snare-Rock-1                     | 2  | Snare-Rock-1-Rimshot       | 3  | Snare-Rock-1-Rimshot-X         |
| 4                             | Snare-Rock-1-Rimshot2            | 5  | Snare-Rock-1-Rimshot3      | 6  | Snare-Rock-1-Rimshot4          |
| 7                             | Snare-Rock-1-Cross-Stick         | 8  | Snare-Rock-1-Cross-Stick2  | 9  | Snare-Rock-1-Cross-Stick3      |
| 10                            | Snare-Rock-2-XL                  | 11 | Snare-Rock-2-S             | 12 | Snare-Rock-2-S-mezzo           |
| 13                            | Snare-Rock-2-S-snappy            | 14 | Snare-Rock-2-RimShot       | 15 | Snare-Rock-2-RimShot-X         |
| 16                            | Snare-Rock-2-RimShot2-X          | 17 | Snare-Rock-2-RimShot3-X    | 18 | Snare-Rock-2-Cross-Stick       |
| 19                            | Snare-Rock-3                     | 20 | Snare-Rock-3-RimShot       | 21 | Snare-Pop-1                    |
| 22                            | Snare-Pop-1-Hi-rimshot           | 23 | Snare-Pop-1-Hi-Rimshot-2   | 24 | Snare-Pop-1-Lo-rimshot-XL      |
| 25                            | Snare-Pop-1-Lo-Rimshot           | 26 | Snare-Pop-1-Lo-Rimshot-2   | 27 | Snare-Pop-1-Lo-Rimshot-3       |

|     |                               |     |                            |     |                             |
|-----|-------------------------------|-----|----------------------------|-----|-----------------------------|
| 28  | Snare-Pop-2-Cross-Stick       | 29  | Snare-Pop-2-Cross-Stick-2  | 30  | Snare-Pop-3                 |
| 31  | Snare-Metal-1-Op-XL           | 32  | Snare-Metal-1-Open         | 33  | Snare-Metal-1-Open-Compact  |
| 34  | Snare-Metal-1-rods-z3-XL      | 35  | Snare-Metal-1-Open-Rimshot | 36  | Snare-Metal-2-Open2         |
| 37  | Snare-Metal-2-Op-rimshot-XL   | 38  | Snare-Metal-2-Op-rimshot   | 39  | Snare-Metal-2-Open-Rimshot  |
| 40  | Snare-Metal-3-rods-XL         | 41  | Snare-Metal-3-rods-S       | 42  | Snare-Metal-3-Open-Rods     |
| 43  | Snare-Metal-3-Rods-Rimshot    | 44  | Snare-Metal-4-XL           | 45  | Snare-Metal-4-S             |
| 46  | Snare-Metal-4-Open-S          | 47  | Snare-Metal-4-RimShot      | 48  | Snare-Jazz-1-XL             |
| 49  | Snare-Jazz-1                  | 50  | Snare-Jazz-1-Snappy        | 51  | Snare-Jazz-1-z2-XL          |
| 52  | Snare-Jazz-1-rimshot-full-XL  | 53  | Snare-Jazz-1-rimshot-full  | 54  | Snare-Jazz-1-rimshot-full2  |
| 55  | Snare-Jazz-1-rimshot-light-XL | 56  | Snare-Jazz-1-rimshot-light | 57  | Snare-Jazz-1-rimshot-light2 |
| 58  | Snare-Jazz-1-cross-stick-XL   | 59  | Snare-Jazz-1-cross-stick   | 60  | Snare-Brush-1-XL            |
| 61  | Snare-Brush-1                 | 62  | Snare-Brush-1-open-X       | 63  | Snare-Brush-1-open          |
| 64  | Snare-Brush-1-Rimsho          | 65  | Snare-Brush-2              | 66  | Snare-Brush-2-XL            |
| 67  | Snare-Jungle-1                | 68  | Snare-Jungle-1-Rimshot-XL  | 69  | Snare-Jungle-1-Rimshot      |
| 70  | Snare-Jungle-1-Rimshot2       | 71  | Snare-Jungle-2             | 72  | Snare-Jungle-2-Rimshot      |
| 73  | Snare-Jungle-2-Rimshot2       | 74  | Snare-Jungle-3             | 75  | Snare-Jungle-3-Rimshot      |
| 76  | Snare-Vintage-1               | 77  | Snare-Vintage-1-z2         | 78  | Snare-Vintage-1-rimshot- X  |
| 79  | Snare-Vintage-1-rimshot       | 80  | Snare-Vintage-1-CrossStick | 81  | Snare-Fiesta-1              |
| 82  | Snare-Fiesta-1-rimshot        | 83  | Snare-Fiesta-1-rimshot2    | 84  | Snare-Fiesta-1-CrossStick   |
| 85  | Snare-Fiesta-2                | 86  | Snare-Fiesta-2-rimshot     | 87  | Snare-Fiesta-2-Rimshot2     |
| 88  | Clap-Electro8                 | 89  | Snare-Electro8-3           | 90  | Snare-Electro8-RS           |
| 91  | Clap-Electro9                 | 92  | Snare-Electro9-1           | 93  | Snare-Electro9-2            |
| 94  | Snare-Electro9-RS             | 95  | Snare-Electro5-1           | 96  | Snare-Electro5-2            |
| 97  | Snare-Electro5-3              | 98  | JazzSnare 01               | 99  | JazzSnare 01 Rimshot        |
| 100 | JazzSnare 02                  | 101 | JazzSnare 02 Rimshot       | 102 | MetalSnare 01               |
| 103 | MetalSnare Rimshot            | 104 | MetalSnare 02              | 105 | MetalSnare Rimshot          |
| 106 | MetalSnare 03                 | 107 | MetalSnare Rimshot         | 108 | PopSnare                    |
| 109 | PopSnare Rimshot              | 110 | RockSnare                  | 111 | RockSnare Rimshot           |
| 112 | RockSnare Sidestick           | 113 | FunkSnare 01               | 114 | FunkSnare Rimshot 01        |
| 115 | FunkSnare 02                  | 116 | FunkSnare Rimshot 02       | 117 | Custom_Snare2               |
| 118 | Custom_Snare2_rim             | 119 | Custom_Snare3              | 120 | Custom_Snare3_rim           |
| 121 | Custom_Snare4                 | 122 | Custom_Snare4_rim          | 123 | Custom_Snare1               |
| 124 | Custom_SnareRimShort1         | 125 | Custom_SnareSideStick 1    |     |                             |

**Toms PC:102 Total=112**

|    |                    |    |                    |    |                    |
|----|--------------------|----|--------------------|----|--------------------|
| 1  | Tom-Rock1-4-XL     | 2  | Tom-Rock1-3-XL     | 3  | Tom-Rock1-2-XL     |
| 4  | Tom-Rock1-1-XL     | 5  | Tom-Rock1-4-Rim    | 6  | Tom-Rock1-3-Rim    |
| 7  | Tom-Rock1-2-Rim    | 8  | Tom-Rock1-1-Rim    | 9  | Tom-Rock1-EQ-4-XL  |
| 10 | Tom-Rock1-EQ-3-XL  | 11 | Tom-Rock1-EQ-2-XL  | 12 | Tom-Rock1-EQ-1-XL  |
| 13 | Tom-Rock1-EQ-4-Rim | 14 | Tom-Rock1-EQ-3-Rim | 15 | Tom-Rock1-EQ-2-Rim |
| 16 | Tom-Rock1-EQ-1-Rim | 17 | Tom-Pop1-4         | 18 | Tom-Pop1-3         |
| 19 | Tom-Pop1-2         | 20 | Tom-Pop1-1         | 21 | Tom-Pop1-4-Rim     |

|     |                    |     |                    |     |                    |
|-----|--------------------|-----|--------------------|-----|--------------------|
| 22  | Tom-Pop1-3-Rim     | 23  | Tom-Pop1-2-Rim     | 24  | Tom-Pop1-1-Rim     |
| 25  | Tom-Vintage1-4     | 26  | Tom-Vintage1-3     | 27  | Tom-Vintage1-2     |
| 28  | Tom-Vintage1-1     | 29  | Tom-Vintage1-4-Rim | 30  | Tom-Vintage1-3-Rim |
| 31  | Tom-Vintage1-2-Rim | 32  | Tom-Vintage1-1-Rim | 33  | Tom-Jazz2-4-XL     |
| 34  | Tom-Jazz2-3-XL     | 35  | Tom-Jazz2-2-XL     | 36  | Tom-Jazz2-1-XL     |
| 37  | Tom-Jazz2-4-Rim    | 38  | Tom-Jazz2-3-Rim    | 39  | Tom-Jazz2-2-Rim    |
| 40  | Tom-Jazz2-1-Rim    | 41  | Tom-Fiesta-4       | 42  | Tom-Fiesta-3       |
| 43  | Tom-Fiesta-2       | 44  | Tom-Fiesta-1       | 45  | Tom-Fiesta-4-Rim   |
| 46  | Tom-Fiesta-3-Rim   | 47  | Tom-Fiesta-2-Rim   | 48  | Tom-Fiesta-1-Rim   |
| 49  | Tom-Metal2-4-XL    | 50  | Tom-Metal2-3-XL    | 51  | Tom-Metal2-2-XL    |
| 52  | Tom-Metal2-1-XL    | 53  | Tom-Metal2-4-Rim   | 54  | Tom-Metal2-3-Rim   |
| 55  | Tom-Metal2-2-Rim   | 56  | Tom-Metal2-1-Rim   | 57  | Tom-Jungle1-4      |
| 58  | Tom-Jungle1-3      | 59  | Tom-Jungle1-2      | 60  | Tom-Jungle1-1      |
| 61  | Tom-Jungle1-4-Rim  | 62  | Tom-Jungle1-3-Rim  | 63  | Tom-Jungle1-2-Rim  |
| 64  | Tom-Jungle1-1-Rim  | 65  | IndieTom1          | 66  | IndieTom2          |
| 67  | IndieTom3          | 68  | IndieTom4          | 69  | IndieTom1_rim      |
| 70  | IndieTom2_rim      | 71  | IndieTom3_rim      | 72  | IndieTom4_rim      |
| 73  | JazzTom1           | 74  | JazzTom2           | 75  | JazzTom3           |
| 76  | JazzTom4           | 77  | JazzTom1_rim       | 78  | JazzTom2_rim       |
| 79  | JazzTom3_rim       | 80  | JazzTom4_rim       | 81  | MetalTom1_2        |
| 82  | MetalTom2_2        | 83  | MetalTom3_2        | 84  | MetalTom4_2        |
| 85  | MetalTom1_rim      | 86  | MetalTom2_rim      | 87  | MetalTom3_rim      |
| 88  | MetalTom4_rim      | 89  | PopTom1            | 90  | PopTom2            |
| 91  | PopTom3            | 92  | PopTom4            | 93  | PopTom1_rim        |
| 94  | PopTom2_rim        | 95  | PopTom3_rim        | 96  | PopTom4_rim        |
| 97  | RockTom1           | 98  | RockTom2           | 99  | RockTom3           |
| 100 | RockTom4           | 101 | RockTom1_rim       | 102 | RockTom2_rim       |
| 103 | RockTom3_rim       | 104 | RockTom4_rim       | 105 | Custom_Btt1        |
| 106 | Custom_Ftt1        | 107 | Custom_Mtt1        | 108 | Custom_Htt1        |
| 109 | Custom_BttRim1     | 110 | Custom_FttRim1     | 111 | Custom_MttRim1     |
| 112 | Custom_HttRim1     |     |                    |     |                    |

**HiHat PC:103 Total=100**

|    |                                 |    |                                 |    |                                 |
|----|---------------------------------|----|---------------------------------|----|---------------------------------|
| 1  | HH_Classic_14_Shoulder_OpenX    | 2  | HH_Classic_14_Shoulder_HalfOp3X | 3  | HH_Classic_14_Shoulder_HalfOp2X |
| 4  | HH_Classic_14_Shoulder_Closed2X | 5  | HH_Classic_14_Edge_OpenX        | 6  | HH_Classic_14_Edge_HalfOp3X     |
| 7  | HH_Classic_14_Edge_HalfOp1X     | 8  | HH_Classic_14_Edge_Closed2X     | 9  | HH_Classic_14_TchickX           |
| 10 | HH_Classic_14_SplashX           | 11 | HH-Rock-Top-open                | 12 | HH-Rock-Top-half4               |
| 13 | HH-Rock-Top-half2               | 14 | HH-Rock-Top-closed              | 15 | HH-Rock-Edge-open-XL            |
| 16 | HH-Rock-Edge-half3              | 17 | HH-Rock-Edge-half1              | 18 | HH-Rock-Edge-closed-XL          |
| 19 | HH-Rock-chick                   | 20 | HH-Rock-splash                  | 21 | HH-Brush-1-open                 |
| 22 | HH-Brush-1-half3                | 23 | HH-Brush-1-closed3              | 24 | HH-Brush-1-chick                |
| 25 | HH-Brush-1-open-XL              | 26 | HH-Brush-1-half2                | 27 | HH-Brush-1-half1                |

|                              |                                |    |                                   |    |                            |
|------------------------------|--------------------------------|----|-----------------------------------|----|----------------------------|
| 28                           | HH-Brush-1-closed              | 29 | HH-Brush-1-chick                  | 30 | HH-Brush-1-splash          |
| 31                           | HH-Fiesta-1-open-rods          | 32 | HH-Fiesta-1-Half2                 | 33 | HH-Fiesta-1-Half1          |
| 34                           | HH-Fiesta-1-closed-top-rods    | 35 | HH-Fiesta-1-open-rods             | 36 | HH-Fiesta-1-Half3          |
| 37                           | HH-Fiesta-1-Half3              | 38 | HH-Fiesta-1-closed-edge2-XL       | 39 | HH-Fiesta-1-chick          |
| 40                           | HH-Fiesta-1-splash             | 41 | HH-Vintage-Top-open               | 42 | HH-Vintage-Top-Half2       |
| 43                           | HH-Vintage-Top-Half1           | 44 | HH-Vintage-Top-closed             | 45 | HH-Vintage-Top-open-XL2    |
| 46                           | HH-Vintage-Top-Half3           | 47 | HH-Vintage-Top- closed3           | 48 | HH-Vintage-Top-closed      |
| 49                           | HH-Vintage-chick               | 50 | HH-Vintage-Splash                 | 51 | HH-Electro8-open           |
| 52                           | HH-Electro8-Half3              | 53 | HH-Electro8-Half1                 | 54 | HH-Electro8-closed         |
| 55                           | HH-Electro8-open               | 56 | HH-Electro8-Half3                 | 57 | HH-Electro8-Half2          |
| 58                           | HH-Electro8-closed             | 59 | HH-Electro8-chick                 | 60 | HH-Electro8-splash         |
| 61                           | IndieHH Open Top               | 62 | IndieHH 1_2 Open Top              | 63 | IndieHH 1_4 Open Top       |
| 64                           | IndieHH Closed Top             | 65 | IndieHH Open Edge                 | 66 | IndieHH 1_2 Open Edge      |
| 67                           | IndieHH 1_4_Open Edge          | 68 | IndieHH Closed Edge               | 69 | IndieHH Pedal              |
| 70                           | IndieHH Splash                 | 71 | JazzHH Open Top                   | 72 | JazzHH 1_2 Open Top        |
| 73                           | JazzHH 1_4 Open Top            | 74 | JazzHH Closed Top                 | 75 | JazzHH Open Edge           |
| 76                           | JazzHH 1_2 Open Edge           | 77 | JazzHH 1_4 Open Edge              | 78 | JazzHH Closed Edgexx       |
| 79                           | JazzHH Pedal                   | 80 | JazzHH Pedal Splash               | 81 | RockHH Open Top            |
| 82                           | RockHH 1_2 Open Top            | 83 | RockHH 1_4 Open Top               | 84 | RockHH Closed Top          |
| 85                           | RockHH Open Edge               | 86 | RockHH 1_2 Open Edge              | 87 | RockHH 1_4 Open Edge       |
| 88                           | RockHH Closed Edge             | 89 | RockHH Pedal                      | 90 | RockHH Splash              |
| 91                           | Custom_HihatOpenTip1           | 92 | Custom_Hihat1_2OpenTip1           | 93 | Custom_Hihat1_4OpenTip1    |
| 94                           | Custom_HihatCloseTip1          | 95 | Custom_HihatOpenShank1            | 96 | Custom_Hihat1_2OpenShank1  |
| 97                           | Custom_Hihat1_4OpenShank1      | 98 | Custom_HihatCloseShank1           | 99 | Custom_HihatOpenPedal1     |
| 100                          | Custom_HihatSplash1            |    |                                   |    |                            |
| <b>Crash PC:104 Total=72</b> |                                |    |                                   |    |                            |
| 1                            | Crash_Classic_CHB_H_Edge       | 2  | Crash_Classic_CHB_H_Shoulder      | 3  | Crash_Rock-V20-Edge        |
| 4                            | Crash_Rock-V20-Shoulder        | 5  | Crash_Dark_C16_Edge               | 6  | Crash_Dark_C16_Shoulder    |
| 7                            | Crash_Dark_B18_Edge            | 8  | Crash_Dark_B18_Shoulder           | 9  | Crash-Rock-1-edge          |
| 10                           | Crash-Rock-1-edge-XL           | 11 | Crash-Rock-2-edge                 | 12 | China-Metal-1              |
| 13                           | China-Metal-1-XL               | 14 | Crash-Metal-2-edge                | 15 | Crash-Metal-2-edge-XL      |
| 16                           | Crash-Metal-2-edge2            | 17 | Crash-Metal-3-edge                | 18 | Crash-Metal-3-edge-XL      |
| 19                           | Crash-Metal-3-edge2            | 20 | Crash-Metal-4-edge                | 21 | Crash-Metal-4-edge-XL      |
| 22                           | Crash-Jazz-1-edge              | 23 | Crash-Jazz-1-edge-XL              | 24 | Crash-Jazz-1-edge2         |
| 25                           | Crash-Jungle-1-edge            | 26 | Crash-Jungle-2-edge               | 27 | Crash-Jungle-3-edge        |
| 28                           | Crash-Jungle-4-splash-hi       | 29 | Crash-Jungle-4-splash-hi-XL       | 30 | Crash-Jungle-4-splash-hi2  |
| 31                           | Crash-Jungle-5-splash-hi-muted | 32 | Crash-Jungle-5-splash-hi-muted-xL | 33 | Crash-Jungle-6-splash-side |
| 34                           | Crash-Jungle-6-splash-side-XL  | 35 | China-Vintage-1                   | 36 | Crash-Vintage-1-edge       |
| 37                           | Crash-Vintage-2-edge           | 38 | Crash-Vintage-3-edge              | 39 | FunkCrash1 01              |
| 40                           | FunkCrash1 02                  | 41 | FunkCrash2 01                     | 42 | FunkCrash2 02              |
| 43                           | FunkSplash 01                  | 44 | FunkSplash 02                     | 45 | HouseCrash 01              |

|                             |                           |    |                           |    |                        |
|-----------------------------|---------------------------|----|---------------------------|----|------------------------|
| 46                          | HouseCrash 02             | 47 | HouseCrash 03             | 48 | HouseCrash 04          |
| 49                          | IndieCrash1 01            | 50 | IndieCrash1 02            | 51 | IndieCrash2 01         |
| 52                          | IndieCrash2 02            | 53 | JazzCrash1 Top            | 54 | JazzCrash2 Top         |
| 55                          | JazzSplash 01             | 56 | JazzSplash 02             | 57 | PopChina               |
| 58                          | PopCrash                  | 59 | RockChina                 | 60 | RockCrash1 Edge        |
| 61                          | RockCrash1 Top            | 62 | RockCrash2 Edge           | 63 | RockCrash2 Top         |
| 64                          | RockSplash                | 65 | TranceCrash1              | 66 | TranceCrash2           |
| 67                          | TrapCrash1 01             | 68 | TrapCrash2 01             | 69 | Custom_CrashEdge1      |
| 70                          | Custom_CrashBow1          | 71 | Std49d_crash1             | 72 | Std57d_crash2          |
| <b>Ride PC:105 Total=71</b> |                           |    |                           |    |                        |
| 1                           | Ride_Rock-ping24-Bell     | 2  | Ride_Rock-ping24-Shoulder | 3  | Ride_Rock-ping24-Edge  |
| 4                           | Ride_Rock-ping24-VeloBell | 5  | Ride_Dark_20_Bell         | 6  | Ride_Dark_20_Shoulder  |
| 7                           | Ride_Dark_20_Edge         | 8  | Ride_Dark_20_VeloBell     | 9  | Ride-Rock-1-top        |
| 10                          | Ride-Rock-1-bell-XL       | 11 | Ride-Rock-1-bell-L        | 12 | Ride-Rock-1-bell       |
| 13                          | Ride-Jazz-1-bell-XL       | 14 | Ride-Jazz-1-bell          | 15 | Ride-Jazz-1-top-XL     |
| 16                          | Ride-Jazz-1-top-L         | 17 | Ride-Jazz-1-top           | 18 | Ride-Jazz-2-bell-XL    |
| 19                          | Ride-Jazz-2-bell          | 20 | Ride-Jazz-2-top-XL        | 21 | Ride-Jazz-2-top        |
| 22                          | Ride-Jazz-2-top2-XL       | 23 | Ride-Jazz-2-top2          | 24 | Ride-Brush-1-bell-XL   |
| 25                          | Ride-Brush-1-bell         | 26 | Ride-Brush-1-top-XL       | 27 | Ride-Brush-1-top       |
| 28                          | Ride-Brush-2-bell         | 29 | Ride-Brush-2-edge         | 30 | Ride-Brush-2-top-hard  |
| 31                          | Ride-Brush-2-top-Soft     | 32 | Ride-Brush-2-top-XL       | 33 | Ride-Jungle-1-bell     |
| 34                          | Ride-Jungle-1-bell-EQ     | 35 | Ride-Jungle-1-top         | 36 | Ride-Jungle-2-shoulder |
| 37                          | Ride-Vintage-1-Bell       | 38 | Ride-Vintage-1-shoulder   | 39 | Ride-Fiesta-1-top      |
| 40                          | Ride-Fiesta-2-top         | 41 | Ride-Metal-1-bell         | 42 | Ride-Metal-1-shoulder  |
| 43                          | Cymb 808L                 | 44 | Shaker-Electro8           | 45 | FunkRide Bell 01       |
| 46                          | FunkRide Bell 02          | 47 | FunkRide Edge 01          | 48 | FunkRide Edge 02       |
| 49                          | FunkRide Top 01           | 50 | FunkRide Top 02           | 51 | IndieRide Bell         |
| 52                          | IndieRide Edge            | 53 | IndieRide Top             | 54 | JazzRide Bell          |
| 55                          | JazzRide Edge             | 56 | JazzRide Top              | 57 | MetalRide Bell         |
| 58                          | MetalRide Edge            | 59 | MetalRide Top             | 60 | PopRide Bell           |
| 61                          | PopRide Edge              | 62 | PopRide Top               | 63 | RockRide Bell          |
| 64                          | RockRide Edge             | 65 | RockRide Top              | 66 | Custom_RideBell1       |
| 67                          | Custom_RideEdge1          | 68 | Custom_RideBow1           | 69 | Std51NEW_ride1         |
| 70                          | Std59NEW_ride2            | 71 | Std53NEW_bell             |    |                        |
| <b>Perc PC:106 Total=33</b> |                           |    |                           |    |                        |
| 1                           | ma808                     | 2  | mcg808                    | 3  | Std54d                 |
| 4                           | Std56d                    | 5  | Std58d                    | 6  | Std60d                 |
| 7                           | Std61d                    | 8  | Std62d                    | 9  | Std63d                 |
| 10                          | Std64d                    | 11 | Std65d                    | 12 | Std66d                 |
| 13                          | Std67d                    | 14 | Std68d                    | 15 | Std69d                 |
| 16                          | Std70d                    | 17 | Std71d                    | 18 | Std72d                 |

|                                |          |    |        |    |          |
|--------------------------------|----------|----|--------|----|----------|
| 19                             | Std73d   | 20 | Std74d | 21 | Std75d   |
| 22                             | Std76d   | 23 | Std77d | 24 | Std78new |
| 25                             | Std79new | 26 | Std80d | 27 | Std81d   |
| 28                             | Std82d   | 29 | Std83d | 30 | Std84d   |
| 31                             | Std85d   | 32 | Std86d | 33 | Std87d   |
| <b>Chinese PC:107 Total=26</b> |          |    |        |    |          |
| 1                              | 戏曲板      | 2  | 编鼓     | 3  | 京戏锣      |
| 4                              | 高音锣 1    | 5  | 高音钹    | 6  | 大鼓       |
| 7                              | 低音锣      | 8  | 中音锣    | 9  | 高音锣 2    |
| 10                             | 高音锣 3    | 11 | 川戏锣 1  | 12 | 川戏锣 2    |
| 13                             | 开道锣      | 14 | 堂鼓 1   | 15 | 堂鼓 2     |
| 16                             | 堂鼓 3     | 17 | 钹 1    | 18 | 钹 1 闷音   |
| 19                             | 钹 2      | 20 | 钹 2 闷音 | 21 | 钹 3      |
| 22                             | 钹 3 闷音   | 23 | 排鼓 1   | 24 | 排鼓 2     |
| 25                             | 排鼓 3     | 26 | 排鼓 4   |    |          |



## Chapter6. Appendix



## 6.1. Drum kit assembly



## STAND



Adjust the position simply loosen two screws

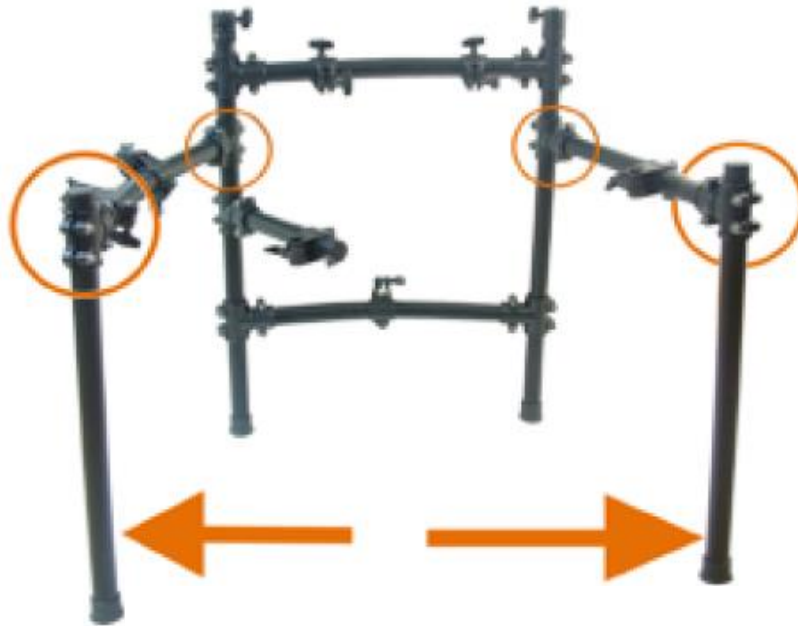

**Distance  $\leq$  1.3m (Less than 1.3m)**

1. Install Kick drum pedal and step on the hammer.
2. L-strut insert drum plate bracket deck.
3. Finally, the Cha piece strut stent insertion clips

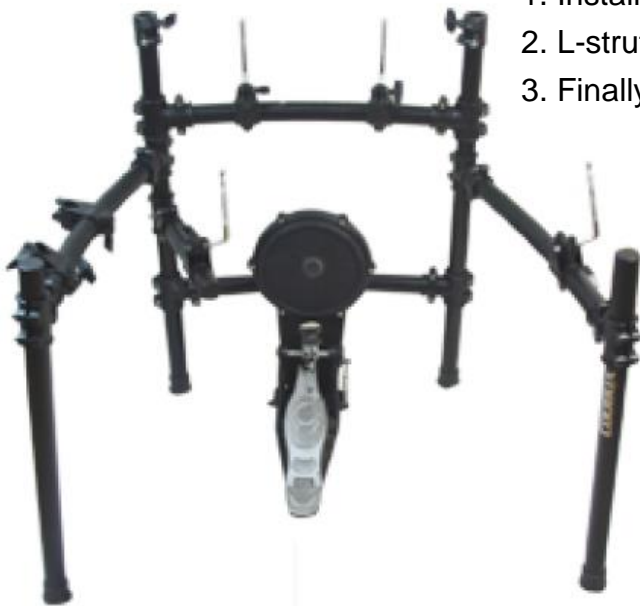

Use black nut to adjust the position.  
Strut toward the direction of the player.

## KICK



## CYMBAL/RIDE

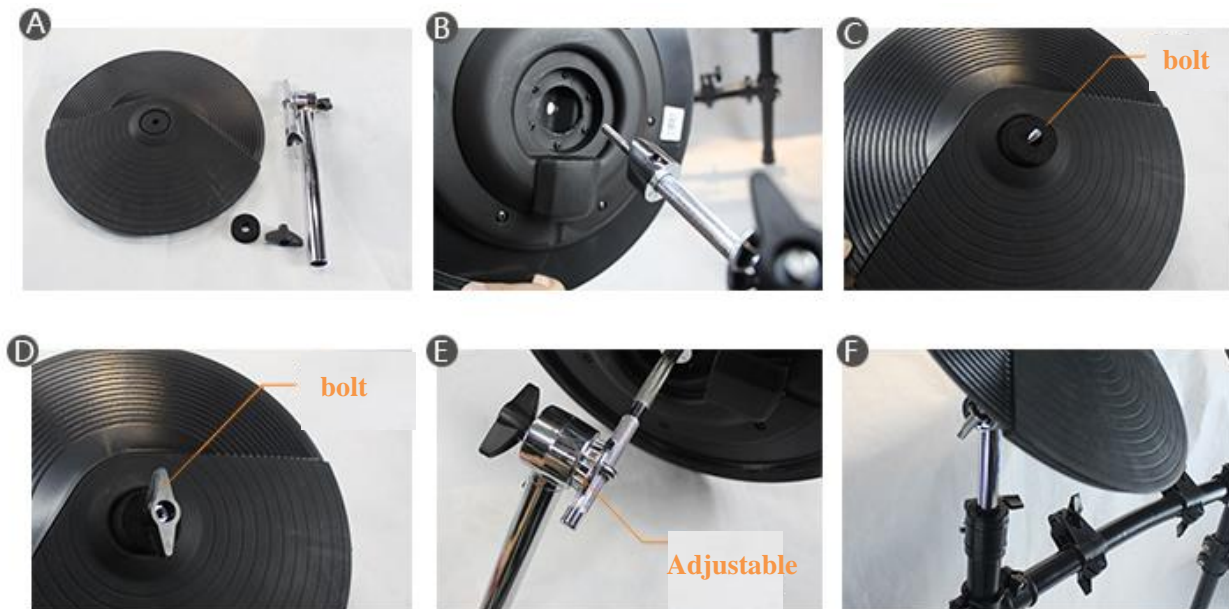

## SNARE



## TOM



## H.H.-CTRL

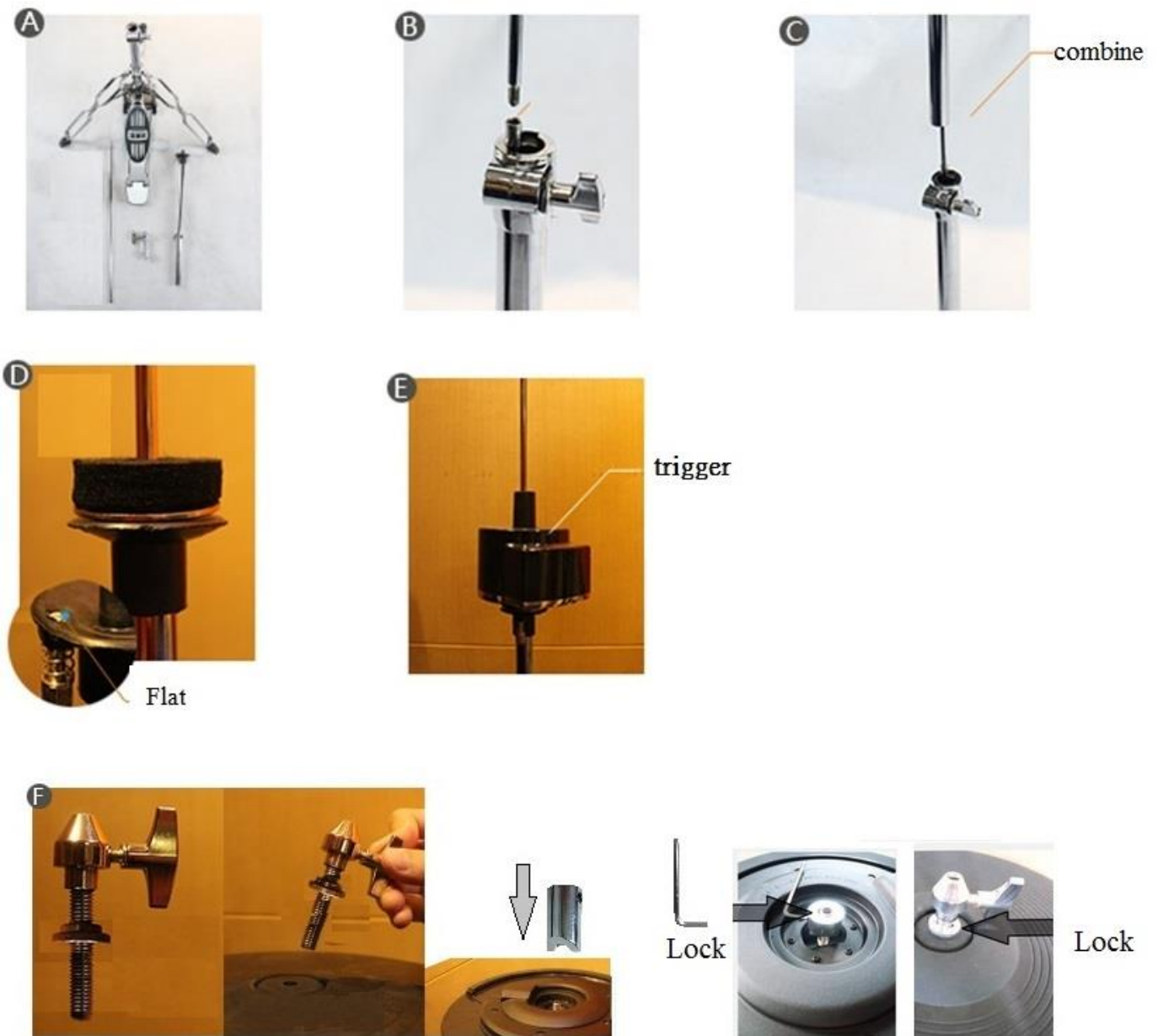

## 6.2. Control box assembly



Z11 come with adaptor and cable DB25



Screw X 3



model rod X1

### ASSEMBLY

The back of the control box has three screw holes aligned holes lever control box, screw lock



Control box assembly to the bracket, lock can be fixed, then the audio cable into the corresponding socket.

