

MIDIPLUS

ED8 Owner's Manual



CONTENTS

Preface.....	1
What's in the Box?.....	1
ED8 Overview.....	1
Caution.....	1
Chapter1. Setup.....	2
1.1. Quick Start	2
1.1.1. Choosing Drum Sounds	2
1.1.2. Playing Along with a Song or MP3	2
1.1.3. Practicing with the Metronome.....	2
1.1.4. Recording Your Performances	2
1.1.5. Playing Your Performances.....	2
1.1.6. Snare Rim shot/Cross stick	2
1.2. Overview	3
1.2.1. Front Panel	3
1.2.2. Rear Panel	4
1.3. Basic settings.....	5
1.3.1. Connect drum accessories	5
1.3.2. Connect headphones or speakers	5
1.3.3. Play the song USB disk(USB MEMORY)	5
1.3.4. USB port	5
1.3.5. Restore factory settings	5
Chapter2. Basic skills	6
2.1. Basic operation.....	6
2.1.1. Adjust the volume	6
2.1.2. Select the Drum Kit.....	6
2.2. Playing in the music accompaniment.....	6
2.2.1. Select Song.....	6
2.2.2. Adjust the song volume/ tempo	6
2.2.3. Song of the drum part mute.....	6
2.2.4. Loop playback of the song	6
2.3. Play music with USB disk(USB MEMORY)	7
2.3.1. Support playback format	7
2.3.2. Sequence of music playing priority	7
2.3.3. Selection of music	7
2.3.4. Select play mode	7
2.3.5. Selection music mode	7
2.4. Using the metronome	8
2.4.1. Start and stop.....	8

2.4.2.	Adjust the tempo	8
2.5.	Record Performance.....	8
2.5.1.	Recording	8
2.5.2.	Playing	8
Chapter3.	Drum group editor.....	9
3.1.	Create your own original sound group.....	9
3.1.1.	Enter edit mode	9
3.1.2.	Select Edit item	9
3.1.3.	Select Edit part	9
3.1.4.	Changing values	9
3.1.5.	Storage edit	9
3.1.6.	Changing values	9
Chapter4.	Advanced Function Setting.....	10
4.1.	Select the set.....	10
4.2.	Sensitive	10
4.3.	Retrig.....	10
4.4.	Thresh.....	10
4.5.	Velocity Curve.....	10
4.6.	X-talk	10
4.7.	Hi-hat splash	10
4.8.	Reverb on/off	10
Chapter5.	Reference	11
5.1.	Inventory data	11
5.1.1.	Drum setting.....	11
5.1.2.	Click setting	11
5.1.3.	Demo setting	11
5.1.4.	Advanced setting.....	12
5.2.	Specification.....	12
5.3.	Drum Voice List	13
Chapter6.	Appendix	19
6.1.	Drum kit assembly	20
6.2.	Control box assembly.....	24

Preface

Thank you for buying a ED8 electronic drums, MIDIPLUS company with the most simple and convenient setting operation mode to make it easier for beginners handy target, please read the instruction manual before use.

What's in the Box?

Included in the **MIDIPLUS ED8** package, you should find:

- One (1) e-drum control Box (Z11 Pro BT)
- One (1) owner's manual
- One (1) 9V DC power adaptor
- One (1) drum stand (attached assembly diagram).
- One (1) package blow kit accessories.

ED8 Overview

The following is provided by the electronic drum ED8 features:

- Built 33 group preset drum kits, 20 user groups may edit drum set, using a true multiple-sampled drum lossless studio recording drums.
- Built-in metronome, 10 demo songs and easy listening learning fast recording function.
- Crash cymbals, support double trigger, cymbals face, cymbals edge and stop tones.
- Ride cymbals, support 3 triggered cymbals face, cymbals heart, cymbal edge and stop tones.
- Pedal cymbals (hi-hat) support closed, semi-open, open, Pedal hi-hat, Foot splash and stop tones.
- Special material multilayer woven mesh drum skin can best simulate real drums crackdown and feel, support dual trigger.
- Kick (Bass drum) and drum kits use a fixed link bracket, firmly positioning drum hit hard step.
- Snare rim can quickly switch Cross-stick, Rim-shot sound.
- Scalable two Crash cymbals (Crash2) and (Crash3), a fourth Tom drum (Tom4).
- Support USB disk MP3, WAV.

Caution

Do not place the power cord near heat sources such as heaters or radiators. Also, do not excessively bend or otherwise damage the cord, or place heavy objects on it.

Only use the voltage specified as correct for the instrument. The required voltage is printed on the name plate of the instrument.

Use the specified adaptor only. Using the wrong adaptor can result in damage to the instrument or overheating.

Check the electric plug periodically and remove any dirt or dust which may have accumulated on it.

Never insert or remove an electric plug with wet hands.

Do not open the instrument or attempt to disassemble or modify the internal components in any way

Chapter1. Setup

1.1. Quick Start

1.1.1. Choosing Drum Sounds

1. Press the [Kit] button.
2. Note display subtitles on the screen, use the [value knob] or [+], [-] button to select the type of drum set.
3. Listen percussion drum set type (preset drum kits 33 groups, 20 user-defined groups).

1.1.2. Playing Along with a Song or MP3

1. Not insert a USB disk, or it is no supporting file for USB disk, Press the [SONG] button, play built-in 10 music MIDI song ,LCD display[Midi song 1],[Volume:85 b=140].
2. Insert USB disk, USB disk with MP3 or WAV file, press [Song] button to play the USB disk song files, the LCD display [USB song: 1], [single stop].
3. Turn the [value knob] or [+], [-] button to select the playback.
4. Press the start / stop button [▶/■] to play or stop demo.

1.1.3. Practicing with the Metronome

1. Press the [Click] button.
2. Turn the [value knob] or [+], [-] button to select the tempo.
3. Press the start / stop button [▶/■] to play or stop tempo.

1.1.4. Recording Your Performances

1. Press the [Rec] button.
2. When the lights begin recording.
3. Then click the [Rec] button.
4. After the lights off to stop recording.

1.1.5. Playing Your Performances

1. Press the [Play] button.
2. When the lights begin playing.
3. Then click the [Play] button.
4. After the lights off to stop playing.

1.1.6. Snare Rim shot/Cross stick

1. Press the [Kit] button. Press the [Mute] button to display the top right corner of the screen displays the CS (cross stick).
2. Then click the [Mute] button, CS disappear (rim shot).

1.2. Overview

1.2.1. Front Panel

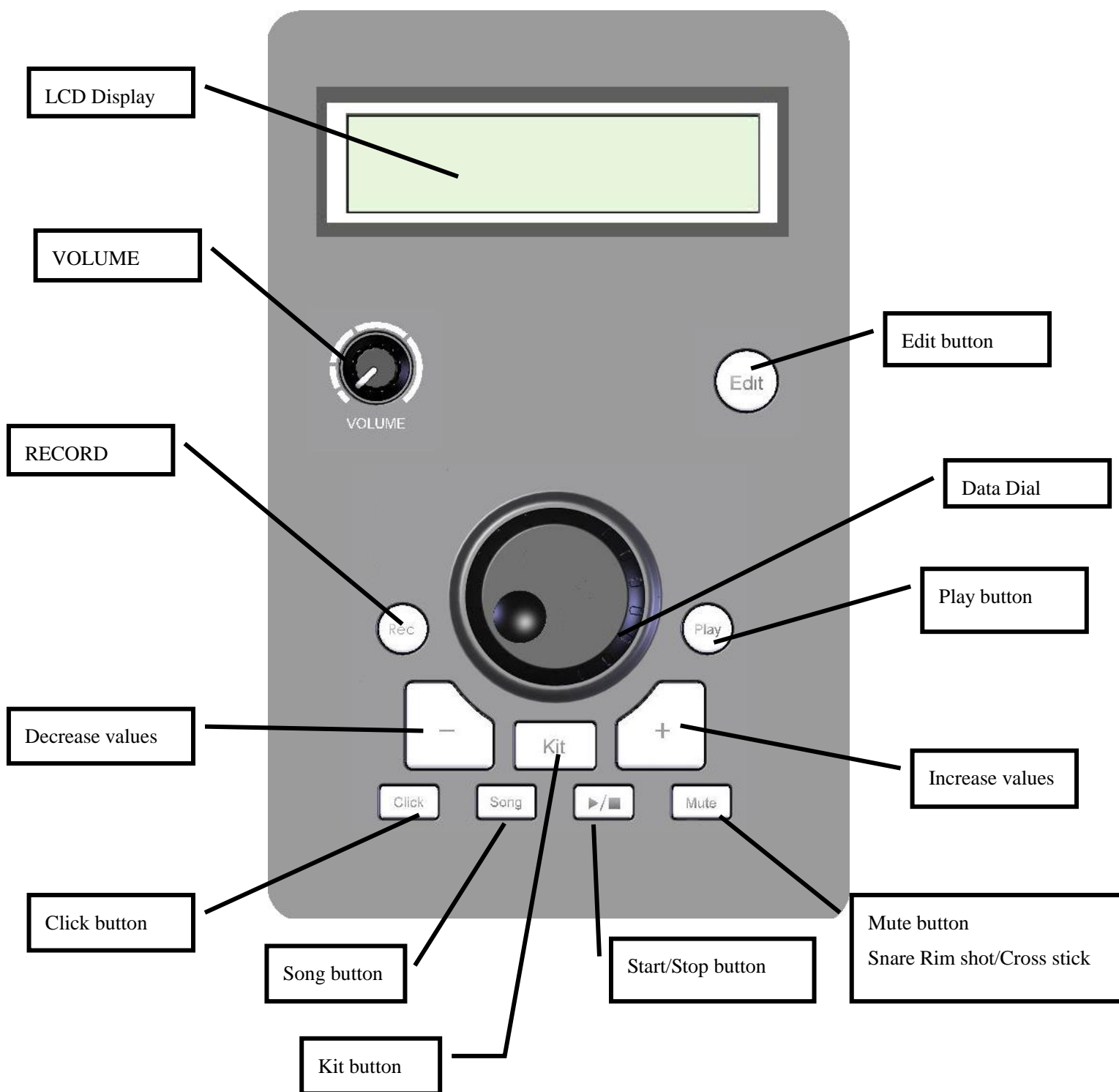

1.2.2. Rear Panel

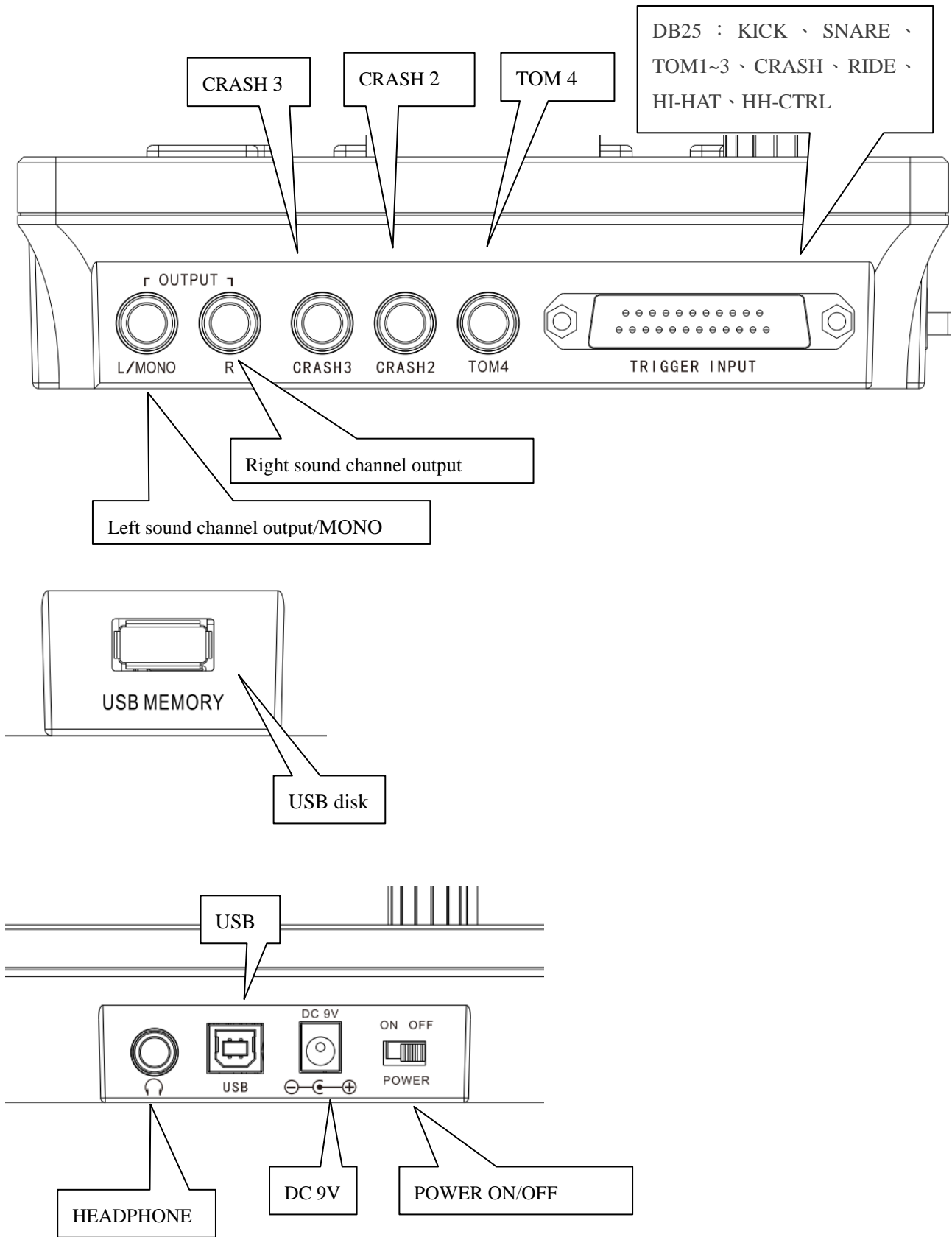

1.3. Basic settings

1.3.1. Connect drum accessories

1. Use the line to connect the drum to [TRIGGER INPUT].
2. Additional expansion [CARSH2],[CARSH3],[TOM4].

1.3.2. Connect headphones or speakers

1. Connect the headset.
The headphone jack is inserted [].
2. Connect the speakers.
The speaker wire is connected to the Output of [L] and [R] jacks (standard mono audio).

1.3.3. Play the song USB disk(USB MEMORY)

After inserting a USB disk with MP3 or WAV songs, press the “SONG” button to automatically search all the song files.

1.3.4. USB port

This jack is used to connect the keyboard with the computer, send MIDI messages directly to the sound card (only drums Channel 10).

1.3.5. Restore factory settings

1. Factory reset all settings.
Before turning the first press [Edit], and then turn on the power switch.
2. The basic rhythm set to restore factory default settings.
Before turning to hold down [Kit], and then turn on the power switch.
3. Advanced Drum Set restores factory default setting.
Before turning to hold down [Mute], then turn on the power switch.

Chapter2. Basic skills

2.1. Basic operation

2.1.1. Adjust the volume

1. Turn the Volume knob to the right, you can turn up the volume.
2. Turn the Volume knob to the left, you can adjust the volume.

2.1.2. Select the Drum Kit

1. Press [Kit] button lights.
2. Note display subtitles on the screen, use the [value knob] or [+], [-] button to select the type of drum set.
3. Percussion Drum group audition type (preset drum kits 20 groups, 10 groups of user-defined).

2.2. Playing in the music accompaniment

2.2.1. Select Song

1. Press [SONG] button lights.
2. Turn the [value knob] or [+], [-] button to select the playback.
3. Press the Start / Stop button [▶/■] to play or stop demo.

2.2.2. Adjust the song volume/ tempo

1. Press the [SONG] button lights.
2. Turn the [value knob] or [+], [-] button to select the playback.
3. Then press the [Edit] button, after the lights, press [SONG] button and select Volume / Tempo option.
4. Turn the [value knob] or [+], [-] button to adjust the music volume.
5. Setup is complete then press [Edit] button, you can put out the lights.

2.2.3. Song of the drum part mute

1. Press the [SONG] button lights.
2. Turn the [value knob] or [+], [-] button to select the playback.
3. When you need to practice on their own drum music, just press [Mute] to mute the music of drums.

2.2.4. Loop playback of the song

1. Press the [SONG] button.
2. Turn the [value knob] or [+], [-] button to select the playback.
3. Press the Start / Stop button [▶/■] to play or stop demo.
4. If there is no press Stop, you can continue to single loop playback.

2.3. Play music with USB disk(USB MEMORY)

2.3.1. Support playback format

1. .MP3
2. .WAV

2.3.2. Sequence of music playing priority

1. Insert a USB disk, the USB disk has a file of .mp3 or .wav format, Press the [SONG] button, LCD display[USB song 1],[single stop].
2. Not insert a USB disk, or it is no supporting file for USB disk, Press the [SONG] button, play built-in 10 music MIDI song, LCD display[Midi song 1],[Volume:85 b=140]..
3. Then press the [Edit] button, after the lights, press [CLICK] button to select Volume /Tempo option.
4. Turn the [value knob] or [+], [-] button to adjust the tempo.
5. Setup is complete then press [Edit] button, you can put out the lights.

2.3.3. Selection of music

1. Insert a USB disk with .mp3 or .wav format.
2. Press [SONG] button to automatically read the music in USB disk (maximum support of 9999).
3. Rotation [knob] or [+], [-] button, choose to play music.
4. Press the Start / Stop button [▶/■] to play or stop music.

2.3.4. Select play mode

1. Press [EDIT] button.
2. Press [SONG] button to select.
3. LCD display [MP3 play mode], [Single Stop], this is to say stop playing after the hit single .MP3 file.
4. Rotation [knob] or [+],[-] button,select All, Single, File,Random, Single Stop, All stop.

Repeat All : Repeat the songs in the all folders.
Repeat Single : Repeat the songs in the current folders.
Repeat File : Repeat a single song.
Random : Play the song randomly.
Single Stop : Play the song of the current folder, it will stop playing.
All Stop : After all the songs are played, stop playing.

2.3.5. Selection music mode

1. Press [EDIT] button, then press [SONG] , LCD display[MP3 EQ mode:] ,[Normal].
2. Rotation [knob] or [+], [-] button, choose Normal, POP, Rock, Jazz, Classic.

2.4. Using the metronome

2.4.1. Start and stop

1. Press [Click] button.
2. Turn the [value knob] or [+], [-] button to select the metronome.
3. Press the Start / Stop button [▶/■] to play or stop the metronome.

2.4.2. Adjust the tempo

1. Press [CLICK] button lights.
2. Turn the [value knob] or [+], [-] button to select the playback.
3. Then press the [Edit] button, after the lights, press [CLICK] button to select Volume /Tempo option.
4. Turn the [value knob] or [+], [-] button to adjust the tempo.
5. Setup is complete then press [Edit] button, you can put out the lights.

2.5. Record Performance

2.5.1. Recording

1. Press [Record]button lights. (automatically deleted Before tracks)
2. Percussion Drum group began recording.
3. Press [Record]button, lights off, it stops recording.

2.5.2. Playing

1. Press the [Play] button lights.
2. Started playing percussion drum set.
3. Press the [Play] button, lights off, it stops recording

Chapter3. Drum group editor

3.1. Create your own original sound group

3.1.1. Enter edit mode

1. Press [Kit] button lights.
2. Then press the [Edit] button, after the lights, enter edit mode.

3.1.2. Select Edit item

Use [Kit] key to select (Voice / volume / Pan / pitch / Reverb /MIDI note) item.

3.1.3. Select Edit part

Knock panel to select the editing position, you can also press [Record] / [Play] option.
(Kick , Snare , Tom1 , Tom2 , Tom3 , Hihat , Hihat-ctrl , Crash , Ride...)

3.1.4. Changing values

By rotating [value knob] or [+], [-] button, to increase its value set.

3.1.5. Storage edit

1. Press the Start / Stop button [▶/■], the screen will display the Store data to?
2. Use the [value knob] or [+], [-] key to select To set the user-defined groups (USER KIT 1 ~ 10)
3. Press the start / stop key [▶/■], the screen will display saving.....
4. The complete storage.

3.1.6. Changing values

Press [Edit] button lights out, exit edit mode.

Chapter4. Advanced Function Setting

4.1. Select the set

Press the [Edit] button, after lights, press [Mute] button to select the option I want to be a set of other adjustments.(Sensitive/Trigger/Thresh/Velosity Curve/X-talk/Hi-hat splash/Reverb)

Press [▶/■] button lights. Screen: Are you sure to Store advance?

Press [▶/■] button lights out.Press [Edit] button, the lamp is off, to complete the setting.

4.2. Sensitive

Detection sensitivity can be adjusted batting drum, each drumhead set independently.

4.3. Retrig

Drum speed can be adjusted to detect batter batting, each drumhead set independently.

4.4. Thresh

The trigger threshold of drums can be adjusted to detect batter batting, each drumhead set independently.

4.5. Velocity Curve

There are four selectable velocity curves, each drumhead independent set.

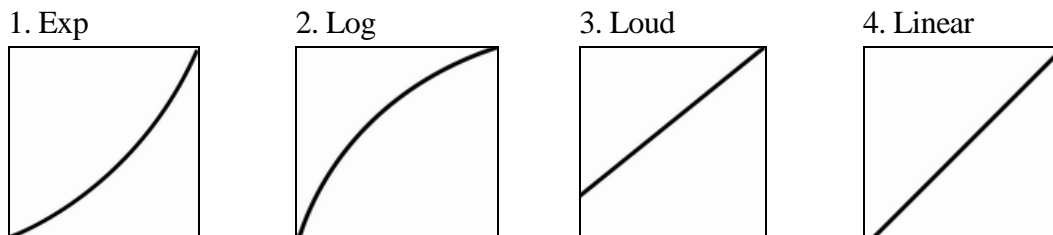

4.6. X-talk

Noise interference when the X-talk larger the value, the better to prevent crosstalk.

4.7. Hi-hat splash

Exclusive adjustment "pedal cymbals" caused by water splashing on the ground similar to the natural sound effects, the more obvious the higher the value.

4.8. Reverb on/off

All drums echo control master switch.

Chapter5. Reference

5.1. Inventory data

5.1.1. Drum setting

Edit + Kit(Cycle selection)	Display	Range
Press Kit Button - 1	Voice	Drum Voice list
Press Kit Button - 2	Volume	0-100
Press Kit Button - 3	Pan	L5~Center~R5
Press Kit Button - 4	Pitch	-12~0~+12
Press Kit Button - 5	Reverb	0~127
Press Kit Button - 6	Midi note	0~127

5.1.2. Click setting

Edit+ Click(Cycle selection)	Display	Range
Press Click Button - 1	Click Volume	0~100
Press Click Button - 2	Click Tempo	30~250

5.1.3. Demo setting

Edit+ Song(Cycle selection)	Display	Range
Press Song Button - 1	Snog Volume	0~100
Press Song Button - 2	Snog Tempo	30~250

5.1.4. Advanced setting

Edit+ Mute(Cycle selection)	Display	Range
Press Mute Button - 1	Sensitive	0~32
Press Mute Button - 2	Retrig	0~50
Press Mute Button - 3	Thresh	0~50
Press Mute Button - 4	Velocity Curve	1~4
Press Mute Button - 5	X-talk	0~100
Press Mute Button - 6	Hi-Hat splash	0~50
Press Mute Button - 7	Reverb	ON/OFF

5.2. Specification

Model	Type	Z11 Pro BT
	Trigger	Kick,Snare,Tom1,Tom2,Tom3,Hihat,Hihat-ctrl, Crash,Ride
	Optional Expansion	Crash2, Crash3, Tom4
	Maximum polyphony	64
	Effect units	reverb
Kit	Classification	Kick, Snare, Tom, Hi-hat, Crash, Ride, percussion
	Number of voices	490
Song	Quantity	10
	Song format	MIDI
USB Disk	Number	999
	Format	.MP3, .WAV
Metronome	Tempo	30-250
	Time signatures	1-6
Audio files	Sampling format	44.1Khz/16bit PCM
Other items	Display	16x2 LCD
	Connectors	line out, head phone, USB, DB25, Tom4, Crash2, Crash3, USBMEMORY

5.3. Drum Voice List

Kick PC:100 Total = 82					
1	Kick-Rock-1	2	Kick-Rock-2	3	Kick-Pop-1-bright
4	Kick-Pop-1-medium	5	Kick-Pop-1-Soft	6	Kck-Pop-1-XL
7	Kick-Pop-2	8	Kick-Pop-3-bright	9	Kick-Pop-3-Medium
10	Kick-Pop-3-Soft	11	Kick-Pop-3-XL	12	Kick-Pop-4-Bright
13	Kick-Pop-4-Deep	14	Kick-Pop-4-Soft	15	Kick-Pop-4-XL
16	Kick-Pop-5	17	Kick-Metal-1-Bright	18	Kick-Metal-1-Deep
19	Kick-Metal-1-Medium	20	Kick-Metal-1-XL	21	Kick-Metal-2
22	Kick-Metal-2-Dry	23	Kick-Metal-2-L	24	Kick-Metal-2-XL
25	Kick-Jazz-1-Bright	26	Kick-Jazz-1-Deep	27	Kick-Jazz-1-Soft
28	Kick-Jazz-1-XL	29	Kick-Jungle-1	30	Kick-Jungle-2-Bright
31	Kick-Jungle-2-Comp	32	Kick-Jungle-2-Comp-Bright	33	Kick-Jungle-2-Comp-Medium
34	Kick-Jungle-2-Comp-XL	35	Kick-Jungle-2-Medium	36	Kick-Jungle-2-XL
37	Kick-Jungle-3-Bright	38	Kick-Jungle-3-Deep	39	Kick-Jungle-3-Medium
40	Kick-Jungle-3-XL	41	Kick-Vintage-1-long	42	Kick-Vintage-2-released-Bright
43	Kick-Vintage-2-released-Medium	44	Kick-Vintage-2-released-XL	45	Kick-Vintage-3-stuck-Bright
46	Kick-Vintage-3-stuck-Bright-Comp	47	Kick-Vintage-3-stuck-Deep	48	Kick-Vintage-3-stuck-Medium
49	Kick-Vintage-3-stuck-XL	50	Kick-Electro8-1	51	Kick-Electro8-Long
52	Kick-Electro8-Long-Soft	53	Kick-Electro8-2	54	Kick-Electro8-Short
55	Kick-Electro9-1	56	Kick-Electro9-1L	57	Kick-Electro9-1V
58	Kick-Electro9-2	59	Kick-Electro9-2L	60	Kick-Electro9-2V
61	Kick-Electro5-1	62	Kick-Electro5-deep	63	Kick-Electro5-short
64	Kick-Electro5-V	65	FunkKick 02	66	HouseKick 02
67	IndieKick 01	68	IndieKick 02	69	JazzKick
70	MetalKick 01	71	MetalKick 02	72	MetalKick 03
73	MetalKick 04	74	PopKick	75	RockKick
76	TechnoKick 04	77	TranceKick 02	78	TranceKick 03
79	TranceKick 04	80	TranceKick 05	81	Custom_Kick2
82	Custom_Kick1				
Snare PC:101 Total=125					
1	Snare-Rock-1	2	Snare-Rock-1-Rimshot	3	Snare-Rock-1-Rimshot-X
4	Snare-Rock-1-Rimshot2	5	Snare-Rock-1-Rimshot3	6	Snare-Rock-1-Rimshot4
7	Snare-Rock-1-Cross-Stick	8	Snare-Rock-1-Cross-Stick2	9	Snare-Rock-1-Cross-Stick3
10	Snare-Rock-2-XL	11	Snare-Rock-2-S	12	Snare-Rock-2-S-mezzo
13	Snare-Rock-2-S-snappy	14	Snare-Rock-2-RimShot	15	Snare-Rock-2-RimShot-X
16	Snare-Rock-2-RimShot2-X	17	Snare-Rock-2-RimShot3-X	18	Snare-Rock-2-Cross-Stick
19	Snare-Rock-3	20	Snare-Rock-3-RimShot	21	Snare-Pop-1
22	Snare-Pop-1-Hi-rimshot	23	Snare-Pop-1-Hi-Rimshot-2	24	Snare-Pop-1-Lo-rimshot-XL
25	Snare-Pop-1-Lo-Rimshot	26	Snare-Pop-1-Lo-Rimshot-2	27	Snare-Pop-1-Lo-Rimshot-3

28	Snare-Pop-2-Cross-Stick	29	Snare-Pop-2-Cross-Stick-2	30	Snare-Pop-3
31	Snare-Metal-1-Op-XL	32	Snare-Metal-1-Open	33	Snare-Metal-1-Open-Compact
34	Snare-Metal-1-rods-z3-XL	35	Snare-Metal-1-Open-Rimshot	36	Snare-Metal-2-Open2
37	Snare-Metal-2-Op-rimshot-XL	38	Snare-Metal-2-Op-rimshot	39	Snare-Metal-2-Open-Rimshot
40	Snare-Metal-3-rods-XL	41	Snare-Metal-3-rods-S	42	Snare-Metal-3-Open-Rods
43	Snare-Metal-3-Rods-Rimshot	44	Snare-Metal-4-XL	45	Snare-Metal-4-S
46	Snare-Metal-4-Open-S	47	Snare-Metal-4-RimShot	48	Snare-Jazz-1-XL
49	Snare-Jazz-1	50	Snare-Jazz-1-Snappy	51	Snare-Jazz-1-z2-XL
52	Snare-Jazz-1-rimshot-full-XL	53	Snare-Jazz-1-rimshot-full	54	Snare-Jazz-1-rimshot-full2
55	Snare-Jazz-1-rimshot-light-XL	56	Snare-Jazz-1-rimshot-light	57	Snare-Jazz-1-rimshot-light2
58	Snare-Jazz-1-cross-stick-XL	59	Snare-Jazz-1-cross-stick	60	Snare-Brush-1-XL
61	Snare-Brush-1	62	Snare-Brush-1-open-X	63	Snare-Brush-1-open
64	Snare-Brush-1-Rimsho	65	Snare-Brush-2	66	Snare-Brush-2-XL
67	Snare-Jungle-1	68	Snare-Jungle-1-Rimshot-XL	69	Snare-Jungle-1-Rimshot
70	Snare-Jungle-1-Rimshot2	71	Snare-Jungle-2	72	Snare-Jungle-2-Rimshot
73	Snare-Jungle-2-Rimshot2	74	Snare-Jungle-3	75	Snare-Jungle-3-Rimshot
76	Snare-Vintage-1	77	Snare-Vintage-1-z2	78	Snare-Vintage-1-rimshot- X
79	Snare-Vintage-1-rimshot	80	Snare-Vintage-1-CrossStick	81	Snare-Fiesta-1
82	Snare-Fiesta-1-rimshot	83	Snare-Fiesta-1-rimshot2	84	Snare-Fiesta-1-CrossStick
85	Snare-Fiesta-2	86	Snare-Fiesta-2-rimshot	87	Snare-Fiesta-2-Rimshot2
88	Clap-Electro8	89	Snare-Electro8-3	90	Snare-Electro8-RS
91	Clap-Electro9	92	Snare-Electro9-1	93	Snare-Electro9-2
94	Snare-Electro9-RS	95	Snare-Electro5-1	96	Snare-Electro5-2
97	Snare-Electro5-3	98	JazzSnare 01	99	JazzSnare 01 Rimshot
100	JazzSnare 02	101	JazzSnare 02 Rimshot	102	MetalSnare 01
103	MetalSnare Rimshot	104	MetalSnare 02	105	MetalSnare Rimshot
106	MetalSnare 03	107	MetalSnare Rimshot	108	PopSnare
109	PopSnare Rimshot	110	RockSnare	111	RockSnare Rimshot
112	RockSnare Sidestick	113	FunkSnare 01	114	FunkSnare Rimshot 01
115	FunkSnare 02	116	FunkSnare Rimshot 02	117	Custom_Snare2
118	Custom_Snare2_rim	119	Custom_Snare3	120	Custom_Snare3_rim
121	Custom_Snare4	122	Custom_Snare4_rim	123	Custom_Snare1
124	Custom_SnareRimShort1	125	Custom_SnareSideStick 1		

Toms PC:102 Total=112

1	Tom-Rock1-4-XL	2	Tom-Rock1-3-XL	3	Tom-Rock1-2-XL
4	Tom-Rock1-1-XL	5	Tom-Rock1-4-Rim	6	Tom-Rock1-3-Rim
7	Tom-Rock1-2-Rim	8	Tom-Rock1-1-Rim	9	Tom-Rock1-EQ-4-XL
10	Tom-Rock1-EQ-3-XL	11	Tom-Rock1-EQ-2-XL	12	Tom-Rock1-EQ-1-XL
13	Tom-Rock1-EQ-4-Rim	14	Tom-Rock1-EQ-3-Rim	15	Tom-Rock1-EQ-2-Rim
16	Tom-Rock1-EQ-1-Rim	17	Tom-Pop1-4	18	Tom-Pop1-3
19	Tom-Pop1-2	20	Tom-Pop1-1	21	Tom-Pop1-4-Rim

22	Tom-Pop1-3-Rim	23	Tom-Pop1-2-Rim	24	Tom-Pop1-1-Rim
25	Tom-Vintage1-4	26	Tom-Vintage1-3	27	Tom-Vintage1-2
28	Tom-Vintage1-1	29	Tom-Vintage1-4-Rim	30	Tom-Vintage1-3-Rim
31	Tom-Vintage1-2-Rim	32	Tom-Vintage1-1-Rim	33	Tom-Jazz2-4-XL
34	Tom-Jazz2-3-XL	35	Tom-Jazz2-2-XL	36	Tom-Jazz2-1-XL
37	Tom-Jazz2-4-Rim	38	Tom-Jazz2-3-Rim	39	Tom-Jazz2-2-Rim
40	Tom-Jazz2-1-Rim	41	Tom-Fiesta-4	42	Tom-Fiesta-3
43	Tom-Fiesta-2	44	Tom-Fiesta-1	45	Tom-Fiesta-4-Rim
46	Tom-Fiesta-3-Rim	47	Tom-Fiesta-2-Rim	48	Tom-Fiesta-1-Rim
49	Tom-Metal2-4-XL	50	Tom-Metal2-3-XL	51	Tom-Metal2-2-XL
52	Tom-Metal2-1-XL	53	Tom-Metal2-4-Rim	54	Tom-Metal2-3-Rim
55	Tom-Metal2-2-Rim	56	Tom-Metal2-1-Rim	57	Tom-Jungle1-4
58	Tom-Jungle1-3	59	Tom-Jungle1-2	60	Tom-Jungle1-1
61	Tom-Jungle1-4-Rim	62	Tom-Jungle1-3-Rim	63	Tom-Jungle1-2-Rim
64	Tom-Jungle1-1-Rim	65	IndieTom1	66	IndieTom2
67	IndieTom3	68	IndieTom4	69	IndieTom1_rim
70	IndieTom2_rim	71	IndieTom3_rim	72	IndieTom4_rim
73	JazzTom1	74	JazzTom2	75	JazzTom3
76	JazzTom4	77	JazzTom1_rim	78	JazzTom2_rim
79	JazzTom3_rim	80	JazzTom4_rim	81	MetalTom1_2
82	MetalTom2_2	83	MetalTom3_2	84	MetalTom4_2
85	MetalTom1_rim	86	MetalTom2_rim	87	MetalTom3_rim
88	MetalTom4_rim	89	PopTom1	90	PopTom2
91	PopTom3	92	PopTom4	93	PopTom1_rim
94	PopTom2_rim	95	PopTom3_rim	96	PopTom4_rim
97	RockTom1	98	RockTom2	99	RockTom3
100	RockTom4	101	RockTom1_rim	102	RockTom2_rim
103	RockTom3_rim	104	RockTom4_rim	105	Custom_Btt1
106	Custom_Ftt1	107	Custom_Mtt1	108	Custom_Htt1
109	Custom_BttRim1	110	Custom_FttRim1	111	Custom_MttRim1
112	Custom_HttRim1				

HiHat PC:103 Total=100

1	HH_Classic_14_Shoulder_OpenX	2	HH_Classic_14_Shoulder_HalfOp3X	3	HH_Classic_14_Shoulder_HalfOp2X
4	HH_Classic_14_Shoulder_Closed2X	5	HH_Classic_14_Edge_OpenX	6	HH_Classic_14_Edge_HalfOp3X
7	HH_Classic_14_Edge_HalfOp1X	8	HH_Classic_14_Edge_Closed2X	9	HH_Classic_14_TchickX
10	HH_Classic_14_SplashX	11	HH-Rock-Top-open	12	HH-Rock-Top-half4
13	HH-Rock-Top-half2	14	HH-Rock-Top-closed	15	HH-Rock-Edge-open-XL
16	HH-Rock-Edge-half3	17	HH-Rock-Edge-half1	18	HH-Rock-Edge-closed-XL
19	HH-Rock-chick	20	HH-Rock-splash	21	HH-Brush-1-open
22	HH-Brush-1-half3	23	HH-Brush-1-closed3	24	HH-Brush-1-chick
25	HH-Brush-1-open-XL	26	HH-Brush-1-half2	27	HH-Brush-1-half1

28	HH-Brush-1-closed	29	HH-Brush-1-chick	30	HH-Brush-1-splash
31	HH-Fiesta-1-open-rods	32	HH-Fiesta-1-Half2	33	HH-Fiesta-1-Half1
34	HH-Fiesta-1-closed-top-rods	35	HH-Fiesta-1-open-rods	36	HH-Fiesta-1-Half3
37	HH-Fiesta-1-Half3	38	HH-Fiesta-1-closed-edge2-XL	39	HH-Fiesta-1-chick
40	HH-Fiesta-1-splash	41	HH-Vintage-Top-open	42	HH-Vintage-Top-Half2
43	HH-Vintage-Top-Half1	44	HH-Vintage-Top-closed	45	HH-Vintage-Top-open-XL2
46	HH-Vintage-Top-Half3	47	HH-Vintage-Top- closed3	48	HH-Vintage-Top-closed
49	HH-Vintage-chick	50	HH-Vintage-Splash	51	HH-Electro8-open
52	HH-Electro8-Half3	53	HH-Electro8-Half1	54	HH-Electro8-closed
55	HH-Electro8-open	56	HH-Electro8-Half3	57	HH-Electro8-Half2
58	HH-Electro8-closed	59	HH-Electro8-chick	60	HH-Electro8-splash
61	IndieHH Open Top	62	IndieHH 1_2 Open Top	63	IndieHH 1_4 Open Top
64	IndieHH Closed Top	65	IndieHH Open Edge	66	IndieHH 1_2 Open Edge
67	IndieHH 1_4_Open Edge	68	IndieHH Closed Edge	69	IndieHH Pedal
70	IndieHH Splash	71	JazzHH Open Top	72	JazzHH 1_2 Open Top
73	JazzHH 1_4 Open Top	74	JazzHH Closed Top	75	JazzHH Open Edge
76	JazzHH 1_2 Open Edge	77	JazzHH 1_4 Open Edge	78	JazzHH Closed Edgexx
79	JazzHH Pedal	80	JazzHH Pedal Splash	81	RockHH Open Top
82	RockHH 1_2 Open Top	83	RockHH 1_4 Open Top	84	RockHH Closed Top
85	RockHH Open Edge	86	RockHH 1_2 Open Edge	87	RockHH 1_4 Open Edge
88	RockHH Closed Edge	89	RockHH Pedal	90	RockHH Splash
91	Custom_HihatOpenTip1	92	Custom_Hihat1_2OpenTip1	93	Custom_Hihat1_4OpenTip1
94	Custom_HihatCloseTip1	95	Custom_HihatOpenShank1	96	Custom_Hihat1_2OpenShank1
97	Custom_Hihat1_4OpenShank1	98	Custom_HihatCloseShank1	99	Custom_HihatOpenPedal1
100	Custom_HihatSplash1				
Crash PC:104 Total=72					
1	Crash_Classic_CHB_H_Edge	2	Crash_Classic_CHB_H_Shoulder	3	Crash_Rock-V20-Edge
4	Crash_Rock-V20-Shoulder	5	Crash_Dark_C16_Edge	6	Crash_Dark_C16_Shoulder
7	Crash_Dark_B18_Edge	8	Crash_Dark_B18_Shoulder	9	Crash-Rock-1-edge
10	Crash-Rock-1-edge-XL	11	Crash-Rock-2-edge	12	China-Metal-1
13	China-Metal-1-XL	14	Crash-Metal-2-edge	15	Crash-Metal-2-edge-XL
16	Crash-Metal-2-edge2	17	Crash-Metal-3-edge	18	Crash-Metal-3-edge-XL
19	Crash-Metal-3-edge2	20	Crash-Metal-4-edge	21	Crash-Metal-4-edge-XL
22	Crash-Jazz-1-edge	23	Crash-Jazz-1-edge-XL	24	Crash-Jazz-1-edge2
25	Crash-Jungle-1-edge	26	Crash-Jungle-2-edge	27	Crash-Jungle-3-edge
28	Crash-Jungle-4-splash-hi	29	Crash-Jungle-4-splash-hi-XL	30	Crash-Jungle-4-splash-hi2
31	Crash-Jungle-5-splash-hi-muted	32	Crash-Jungle-5-splash-hi-muted-xL	33	Crash-Jungle-6-splash-side
34	Crash-Jungle-6-splash-side-XL	35	China-Vintage-1	36	Crash-Vintage-1-edge
37	Crash-Vintage-2-edge	38	Crash-Vintage-3-edge	39	FunkCrash1 01
40	FunkCrash1 02	41	FunkCrash2 01	42	FunkCrash2 02
43	FunkSplash 01	44	FunkSplash 02	45	HouseCrash 01

46	HouseCrash 02	47	HouseCrash 03	48	HouseCrash 04
49	IndieCrash1 01	50	IndieCrash1 02	51	IndieCrash2 01
52	IndieCrash2 02	53	JazzCrash1 Top	54	JazzCrash2 Top
55	JazzSplash 01	56	JazzSplash 02	57	PopChina
58	PopCrash	59	RockChina	60	RockCrash1 Edge
61	RockCrash1 Top	62	RockCrash2 Edge	63	RockCrash2 Top
64	RockSplash	65	TranceCrash1	66	TranceCrash2
67	TrapCrash1 01	68	TrapCrash2 01	69	Custom_CrashEdge1
70	Custom_CrashBow1	71	Std49d_crash1	72	Std57d_crash2
Ride PC:105 Total=71					
1	Ride_Rock-ping24-Bell	2	Ride_Rock-ping24-Shoulder	3	Ride_Rock-ping24-Edge
4	Ride_Rock-ping24-VeloBell	5	Ride_Dark_20_Bell	6	Ride_Dark_20_Shoulder
7	Ride_Dark_20_Edge	8	Ride_Dark_20_VeloBell	9	Ride-Rock-1-top
10	Ride-Rock-1-bell-XL	11	Ride-Rock-1-bell-L	12	Ride-Rock-1-bell
13	Ride-Jazz-1-bell-XL	14	Ride-Jazz-1-bell	15	Ride-Jazz-1-top-XL
16	Ride-Jazz-1-top-L	17	Ride-Jazz-1-top	18	Ride-Jazz-2-bell-XL
19	Ride-Jazz-2-bell	20	Ride-Jazz-2-top-XL	21	Ride-Jazz-2-top
22	Ride-Jazz-2-top2-XL	23	Ride-Jazz-2-top2	24	Ride-Brush-1-bell-XL
25	Ride-Brush-1-bell	26	Ride-Brush-1-top-XL	27	Ride-Brush-1-top
28	Ride-Brush-2-bell	29	Ride-Brush-2-edge	30	Ride-Brush-2-top-hard
31	Ride-Brush-2-top-Soft	32	Ride-Brush-2-top-XL	33	Ride-Jungle-1-bell
34	Ride-Jungle-1-bell-EQ	35	Ride-Jungle-1-top	36	Ride-Jungle-2-shoulder
37	Ride-Vintage-1-Bell	38	Ride-Vintage-1-shoulder	39	Ride-Fiesta-1-top
40	Ride-Fiesta-2-top	41	Ride-Metal-1-bell	42	Ride-Metal-1-shoulder
43	Cymb 808L	44	Shaker-Electro8	45	FunkRide Bell 01
46	FunkRide Bell 02	47	FunkRide Edge 01	48	FunkRide Edge 02
49	FunkRide Top 01	50	FunkRide Top 02	51	IndieRide Bell
52	IndieRide Edge	53	IndieRide Top	54	JazzRide Bell
55	JazzRide Edge	56	JazzRide Top	57	MetalRide Bell
58	MetalRide Edge	59	MetalRide Top	60	PopRide Bell
61	PopRide Edge	62	PopRide Top	63	RockRide Bell
64	RockRide Edge	65	RockRide Top	66	Custom_RideBell1
67	Custom_RideEdge1	68	Custom_RideBow1	69	Std51NEW_ride1
70	Std59NEW_ride2	71	Std53NEW_bell		
Perc PC:106 Total=33					
1	ma808	2	mcg808	3	Std54d
4	Std56d	5	Std58d	6	Std60d
7	Std61d	8	Std62d	9	Std63d
10	Std64d	11	Std65d	12	Std66d
13	Std67d	14	Std68d	15	Std69d
16	Std70d	17	Std71d	18	Std72d

19	Std73d	20	Std74d	21	Std75d
22	Std76d	23	Std77d	24	Std78new
25	Std79new	26	Std80d	27	Std81d
28	Std82d	29	Std83d	30	Std84d
31	Std85d	32	Std86d	33	Std87d
Chinese PC:107 Total=26					
1	戏曲板	2	编鼓	3	京戏锣
4	高音锣 1	5	高音钹	6	大鼓
7	低音锣	8	中音锣	9	高音锣 2
10	高音锣 3	11	川戏锣 1	12	川戏锣 2
13	开道锣	14	堂鼓 1	15	堂鼓 2
16	堂鼓 3	17	钹 1	18	钹 1 闷音
19	钹 2	20	钹 2 闷音	21	钹 3
22	钹 3 闷音	23	排鼓 1	24	排鼓 2
25	排鼓 3	26	排鼓 4		

Chapter6. Appendix



6.1. Drum kit assembly



STAND



Adjust the position simply loosen two screws



Distance \leq 1.3m (Less than 1.3m)

1. Install Kick drum pedal and step on the hammer.
2. L-strut insert drum plate bracket deck.
3. Finally, the Cha piece strut stent insertion clips

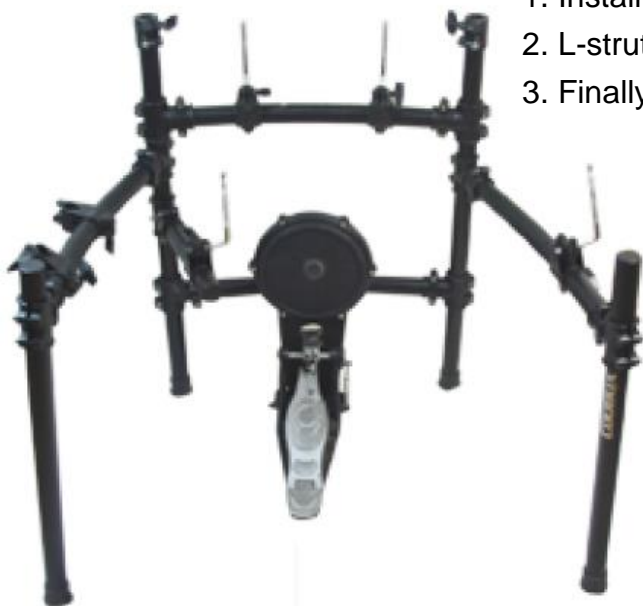

the bolt

Use black nut to adjust the position.
Strut toward the direction of the player.

KICK



CYMBAL/RIDE

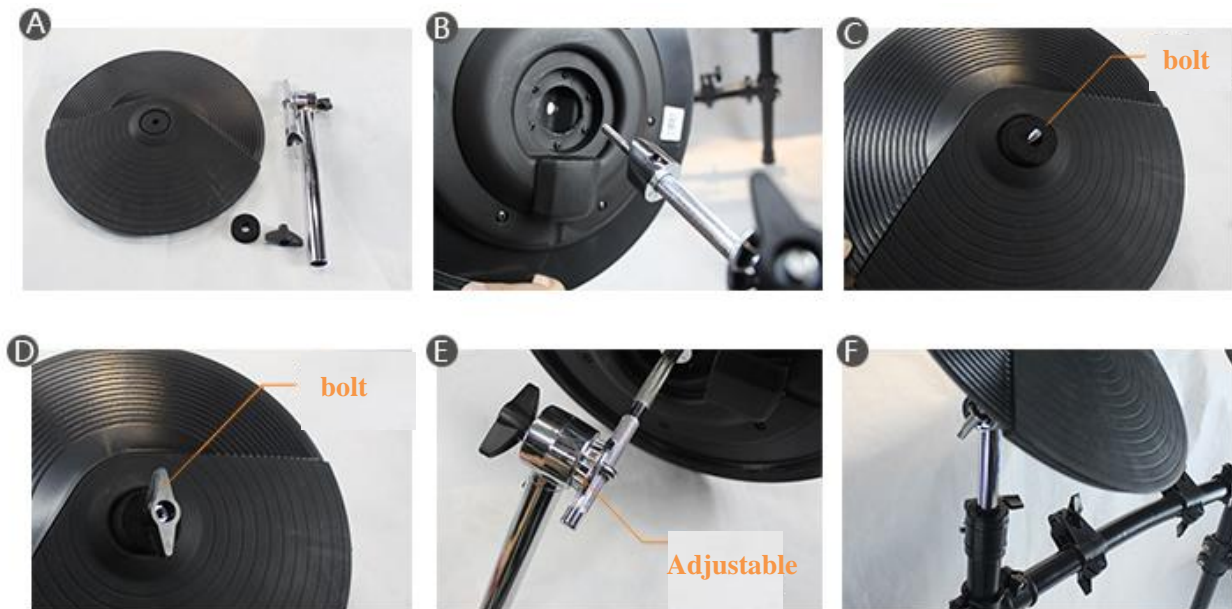

SNARE

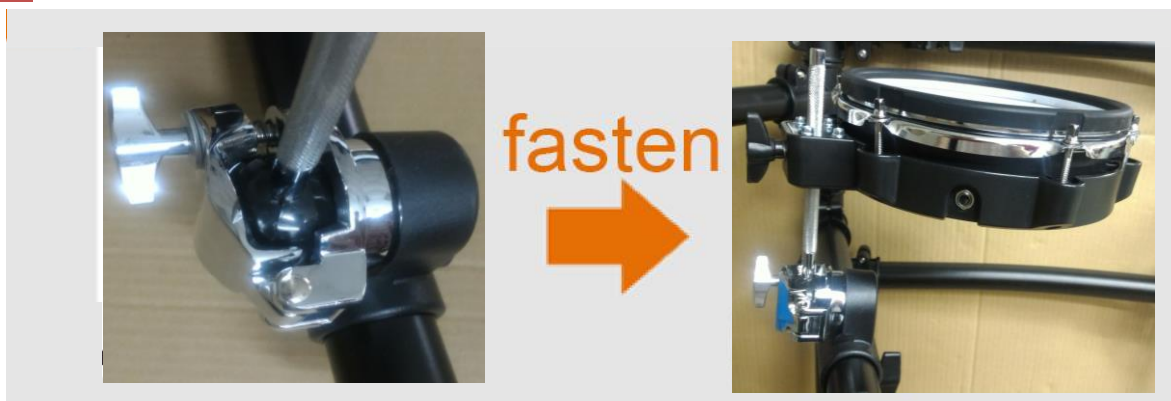

TOM



H.H.-CTRL

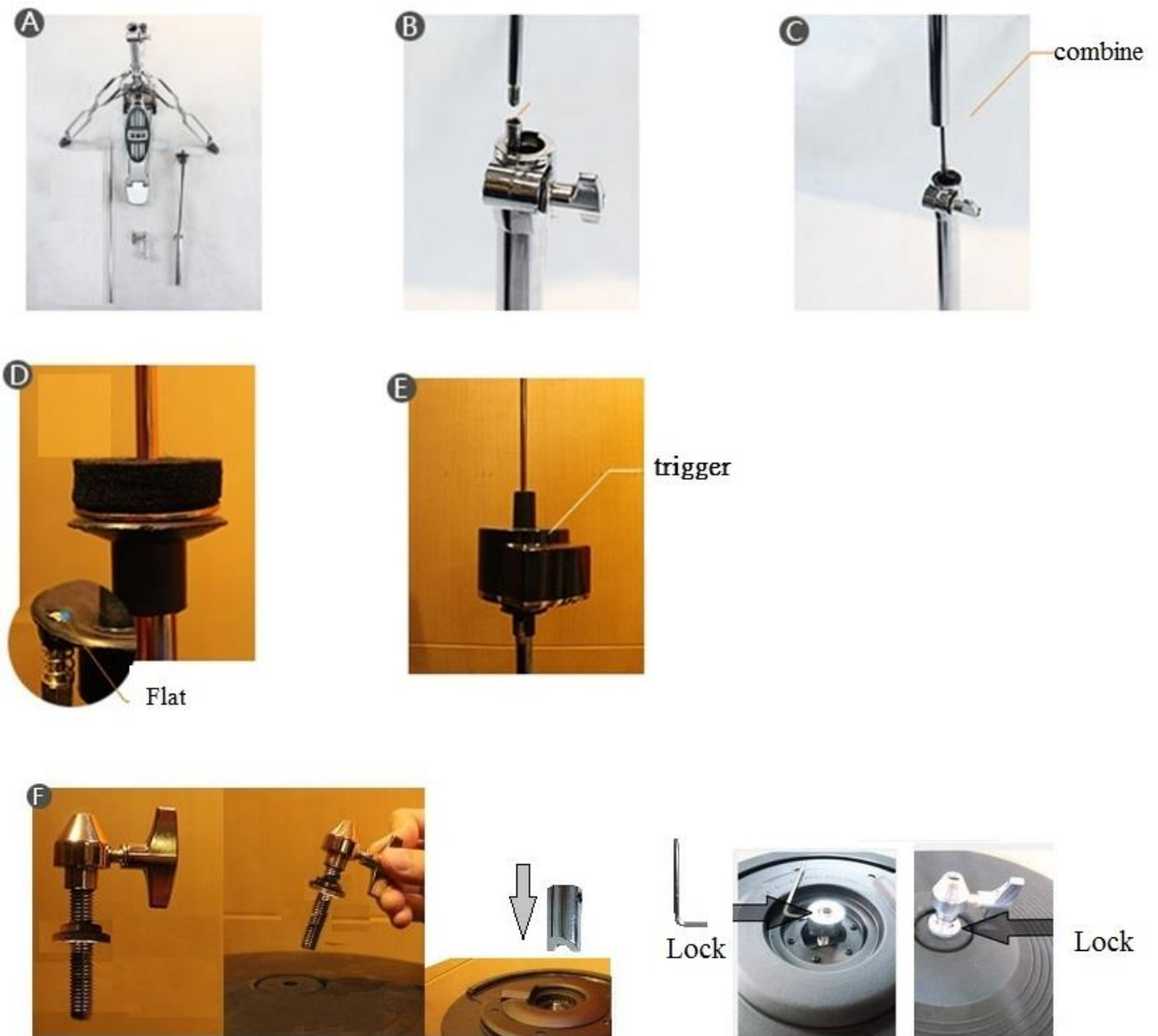

6.2. Control box assembly



Z11 come with adaptor and cable DB25



Screw X 3



model rod X1

ASSEMBLY

The back of the control box has three screw holes aligned holes lever control box, screw lock

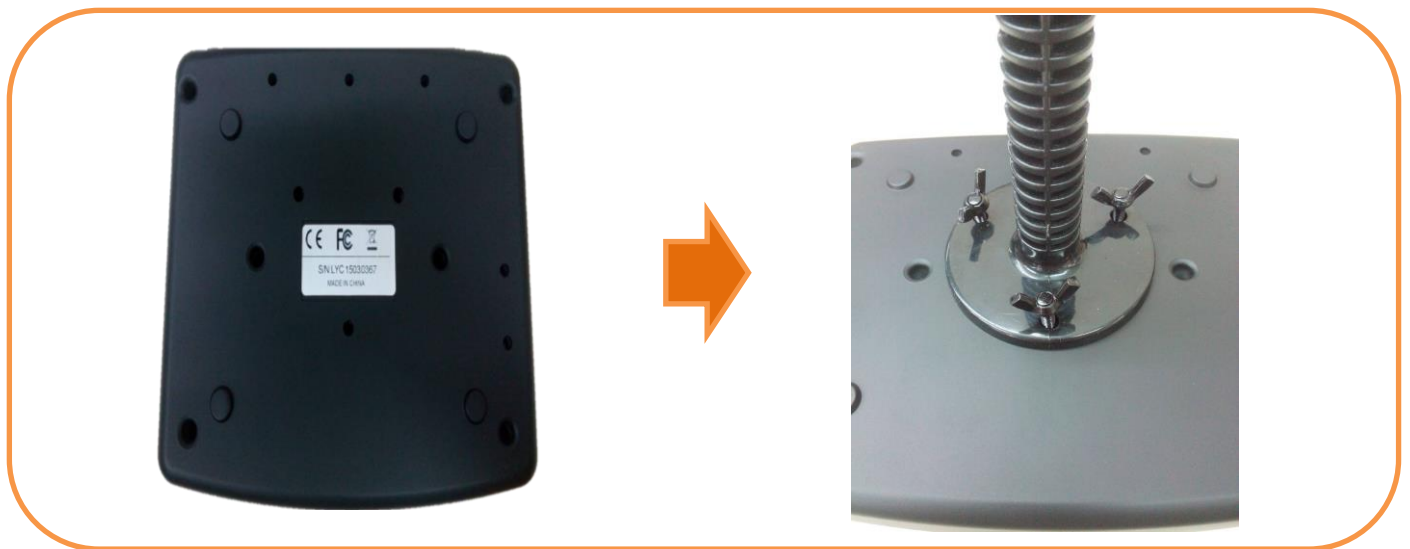

Control box assembly to the bracket, lock can be fixed, then the audio cable into the corresponding socket.

